

MRM 120

Montageanleitung Mounting assembly

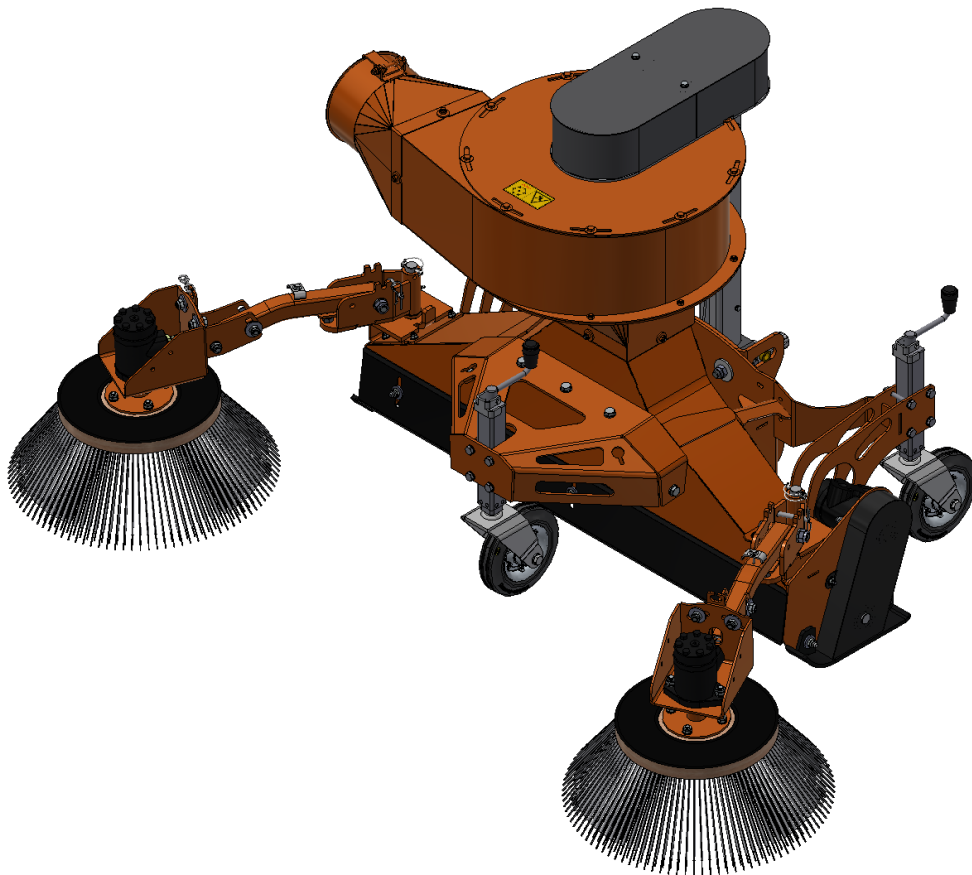



Montagearbeiten an sicherheitsrelevanten Teilen wie z.B. Fahrwerken (Achsen, Radaufhängungen, Räder usw.), an Zug- und Hebeeinrichtungen (Deichseln, Heckdreipunkt, Frontkraftheber, Zwischenachsaushebungen) und Bremsen dürfen nur von Personal mit nachfolgender Qualifikation ausgeführt werden:



- Sie haben eine fachbezogene Ausbildung, wie z.B. Landmaschinenmechaniker, KFZ-Mechaniker usw.
- Personen ohne qualifizierte Ausbildung müssen von einer Person mit qualifizierter Ausbildung beaufsichtigt werden.
- Sie haben diese Montageanleitung gelesen und verstanden.

Die Sicherheits- und Unfallverhütungsvorschriften sind in jedem Land gesetzlich geregelt. Für die Einhaltung der gültigen Vorschriften ist der Werkstatteleiter bzw. die bestellte Fachkraft für Arbeitssicherheit des ausführenden Betriebs verantwortlich.

Installation work on safety-relevant parts such as chassis (axles, wheel suspensions, wheels, etc.), on towing and lifting equipment (drawbars, rear three-point hitch, front power lift, intermediate axle lift) and brakes may only be carried out by personnel with the following qualifications



- They have specialist training, e.g. agricultural machinery mechanics, car mechanics, etc.
- Persons without qualified training must be supervised by a person with qualified training.
- You have read and understood these assembly instructions.

The safety and accident prevention regulations are regulated by law in every country. The factory foreman or the appointed specialist for work safety of the company carrying out the work is responsible for compliance with the valid regulations.



Symbolik

Symbolism



Nachfolgend finden Sie die in der Montageanleitung verwendeten Symbole. Bitte machen Sie sich mit diesen Symbolen vertraut, bevor Sie die Montage beginnen.



The following are the symbols used in the assembly instructions. Please make yourself familiar with these symbols before you start the assembly.

Bringen Sie das Gerät mit geeigneten Hilfsmitteln in eine sichere Montageposition. Die Abbildungen in der Anleitung sind nur beispielhaft. Von ihnen kann keine sichere Montageposition abgeleitet werden.

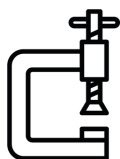

Use suitable tools to bring the device into a safe mounting position. The illustrations in the instructions are only exemplary. No safe mounting position can be derived from them.

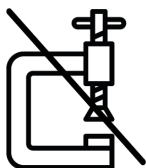

Entfernen Sie die Montagehilfsmittel.

Remove the installation aids.

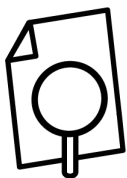

Die Montageschritte sind in der genannten Dokumentation erläutert. Sollte Ihnen diese Dokumentation nicht vorliegen, wenden sie sich an die matev GmbH.

The installation steps are explained in the documentation mentioned above. If you do not have this documentation, please contact matev GmbH.



Montageschritte für die keine Werkzeuge benötigt werden.

Assembly steps for which no tools are required.



Symbolik

Symbolism



Verwenden Sie geeignete Werkzeuge.

Use suitable tools.



Verwenden Sie geeignete Werkzeuge und halten Sie für die Schraubenverbindungen das angegebene Drehmoment ein. Das Drehmoment gilt für trockene Schrauben.

Use suitable tools and observe the given torque for the screw connections. The torque applies to dry screws. .



Die Abbildung dient der Verdeutlichung des nachfolgenden Montage-schritts. Bitte montieren Sie dieses Teil wie im nächsten Montageschritt dargestellt.

The illustration serves to clarify the following assembly step. Please mount this part as shown in the next mounting step.



Einstellen nach Maß! Siehe Betriebsanleitung.

Adjustment made to measure! See operating instructions.



Maschinenspezifisches oder optionales Zubehör.

Machine specific or optional accessories.



MRM Grundgerät basic unit

Montageanleitung Mounting assembly

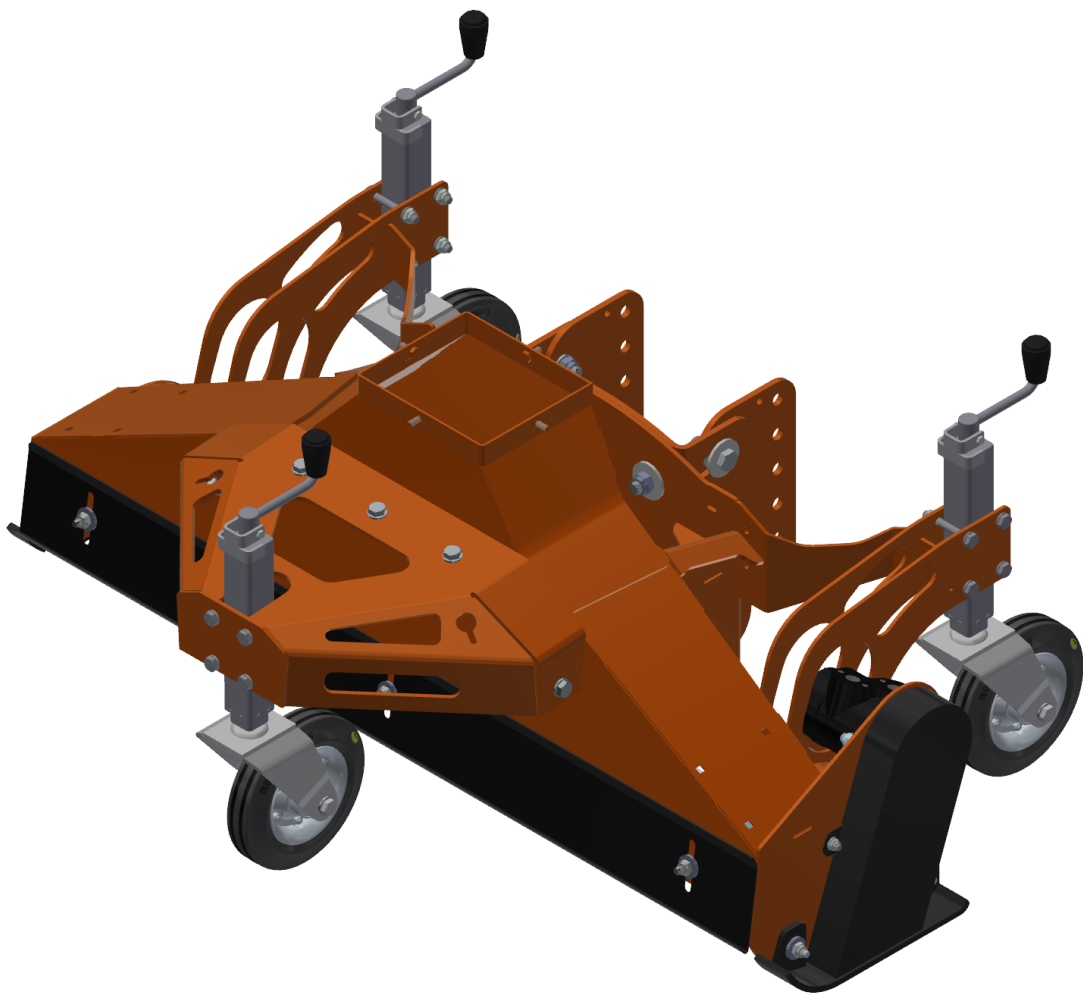

1

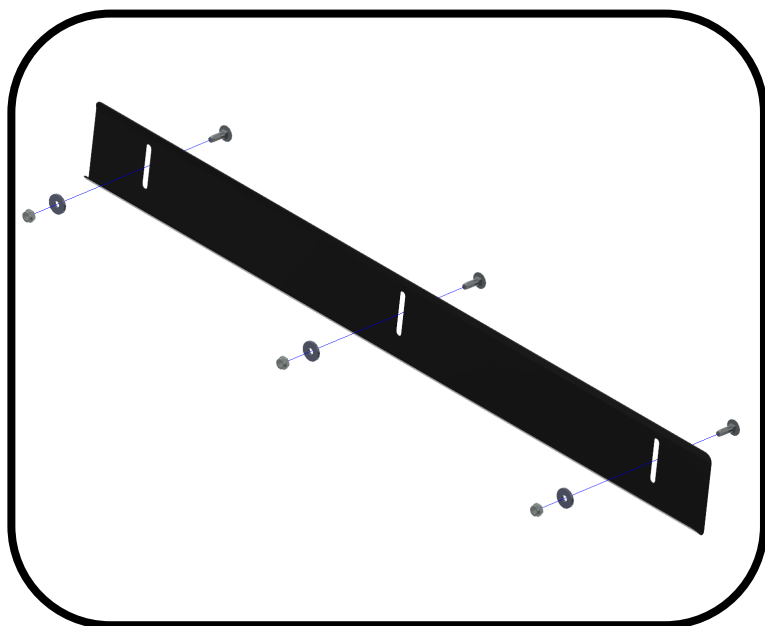

3x DIN 603 M10x30
3x DIN 985-M10
3x DIN 522-10,5x30x4

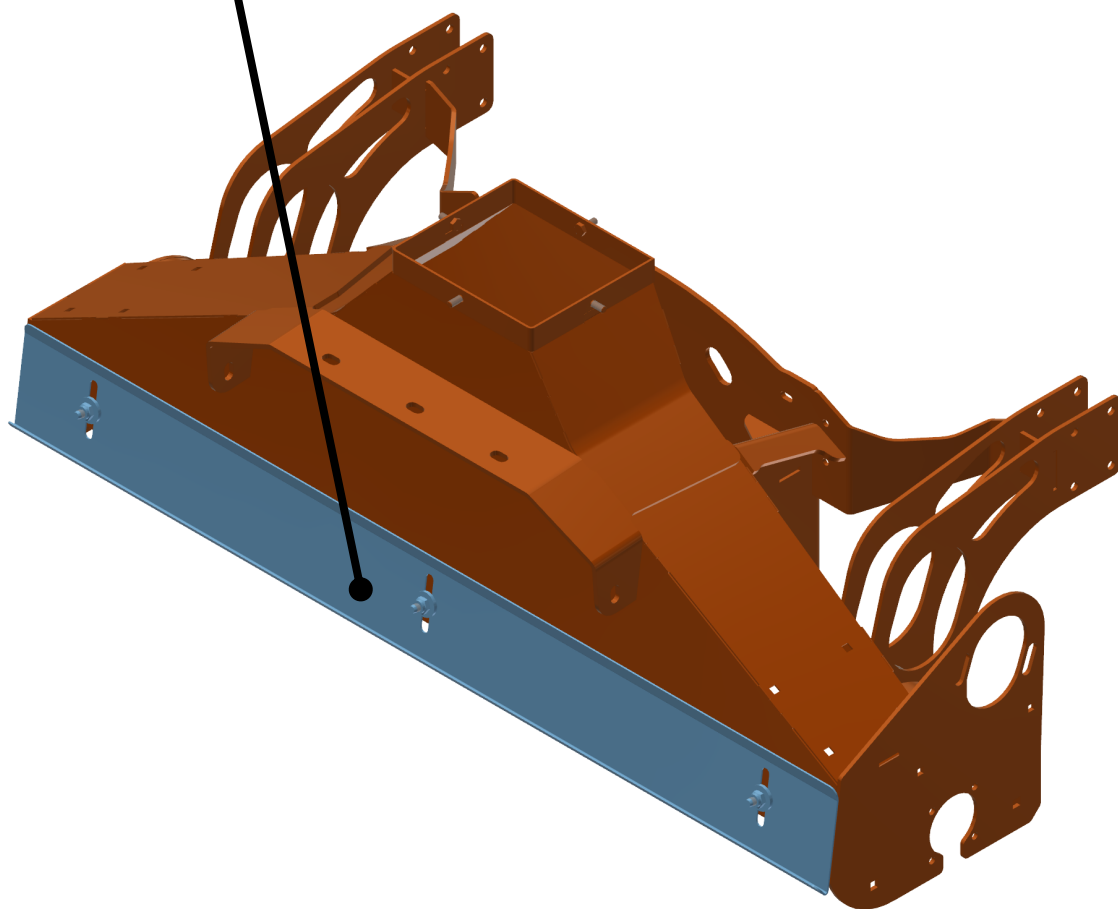

2

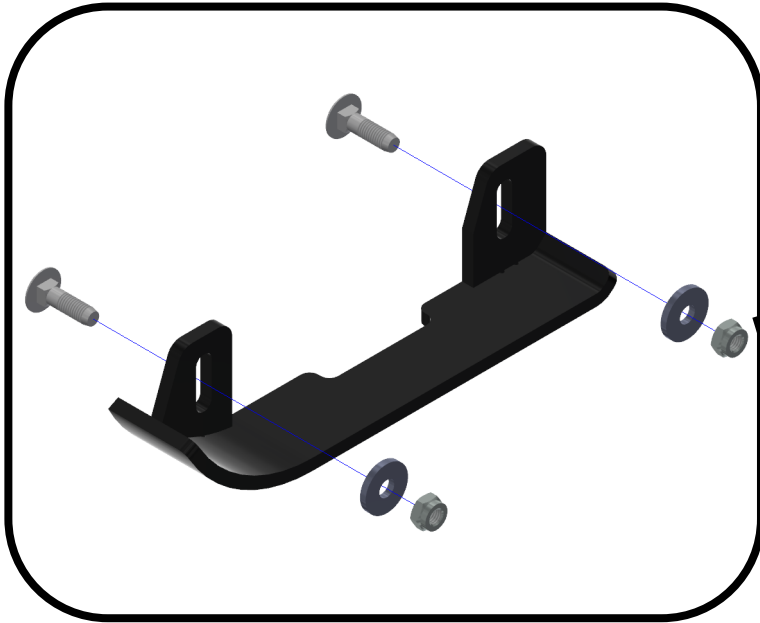

3x DIN 603 M10x35
3x DIN 985-M10
3x DIN 522-10,5x30x4

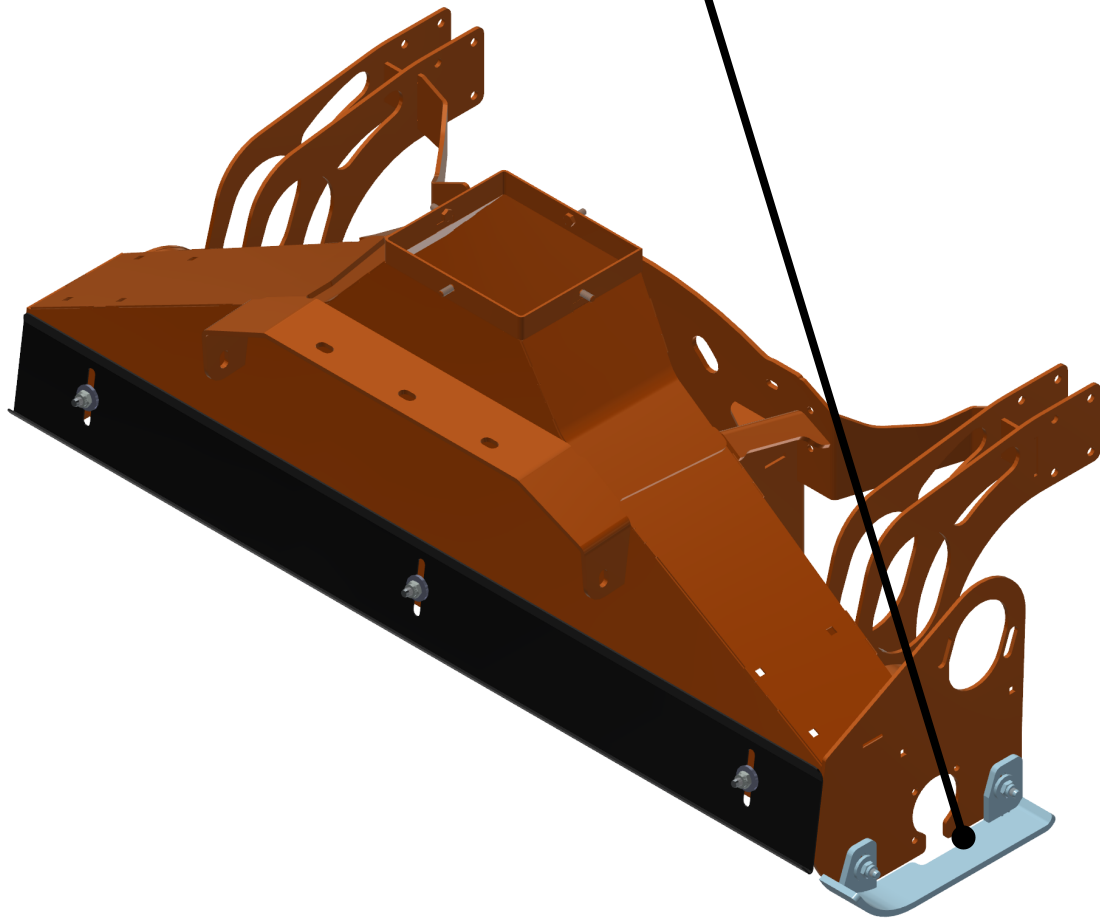

3

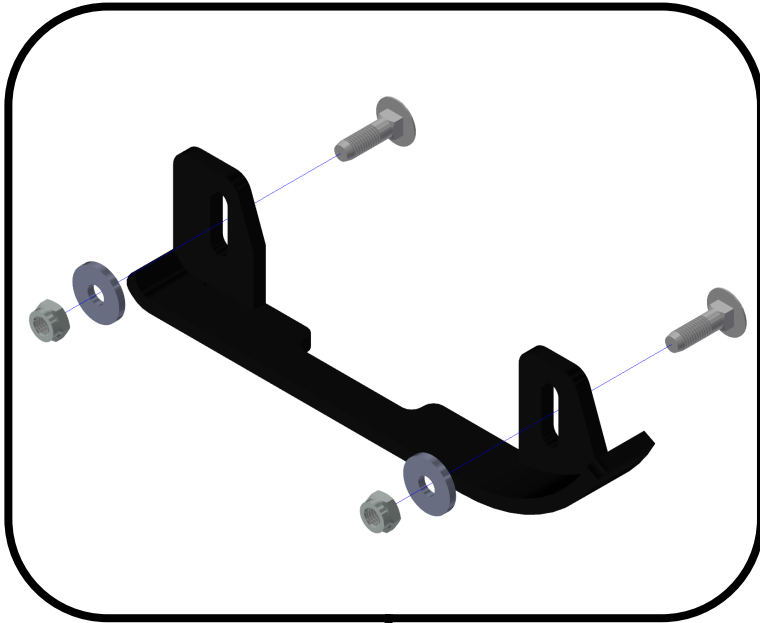

3x DIN 603 M10x35
3x DIN 985-M10
3x DIN 522-10,5x30x4

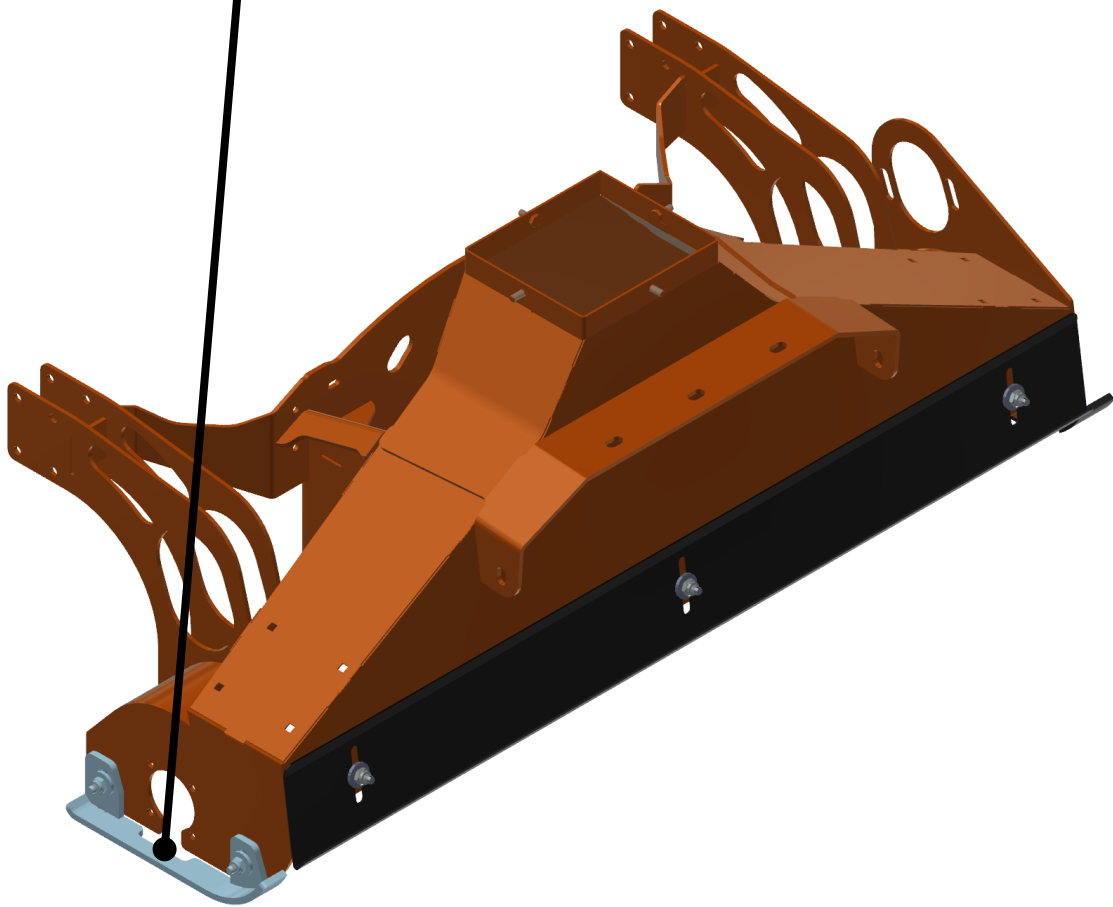

4

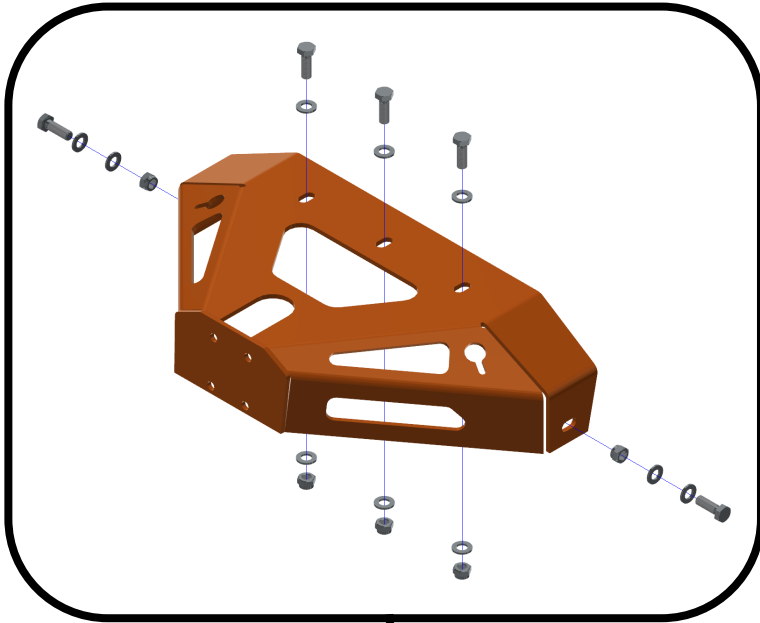

5x DIN 933-M12x35
5x DIN 985-M12
10x DIN 125-A13

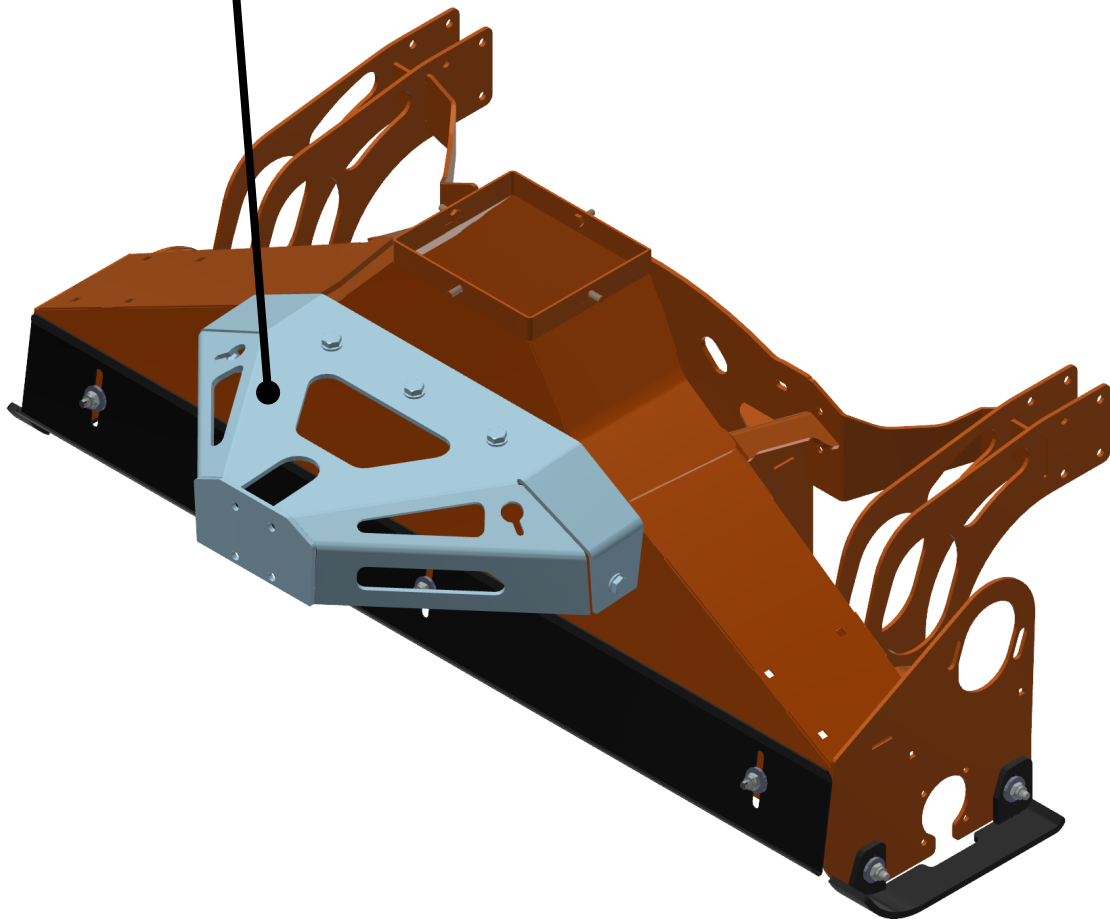

5



8x DIN 931-M10x75
8x DIN 985-M10
16x DIN 125-A-10

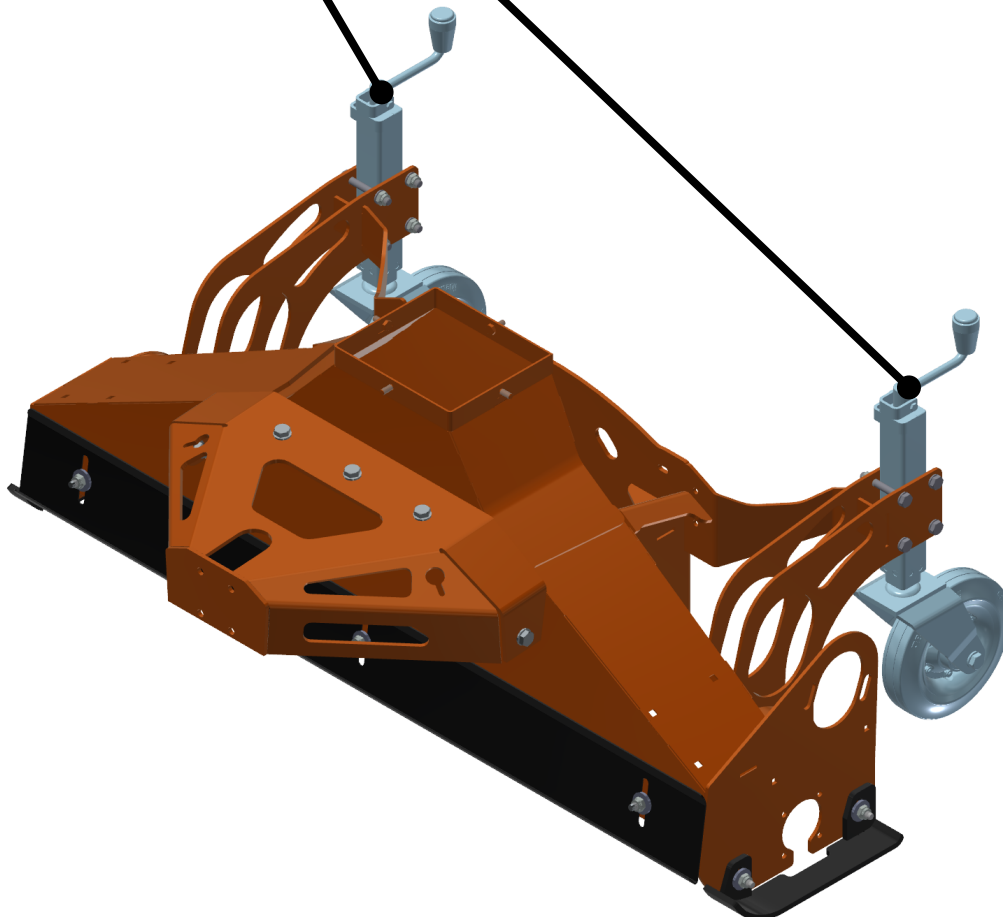
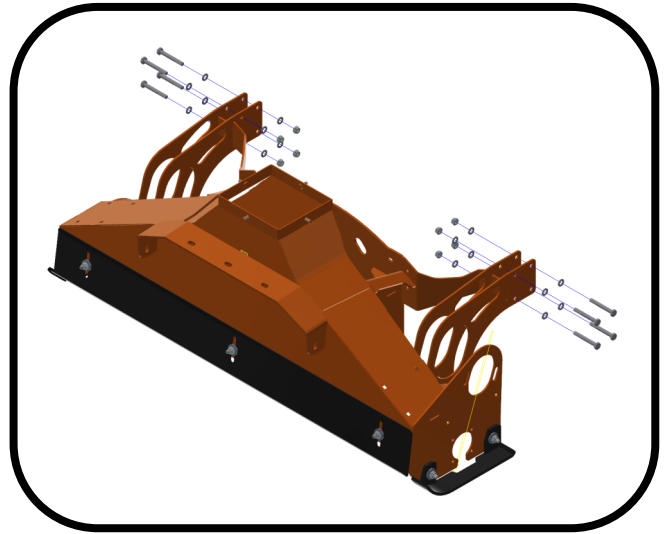

6



4x DIN 931-M10x75
4x DIN 985-M10
8x DIN 125-A-10.5

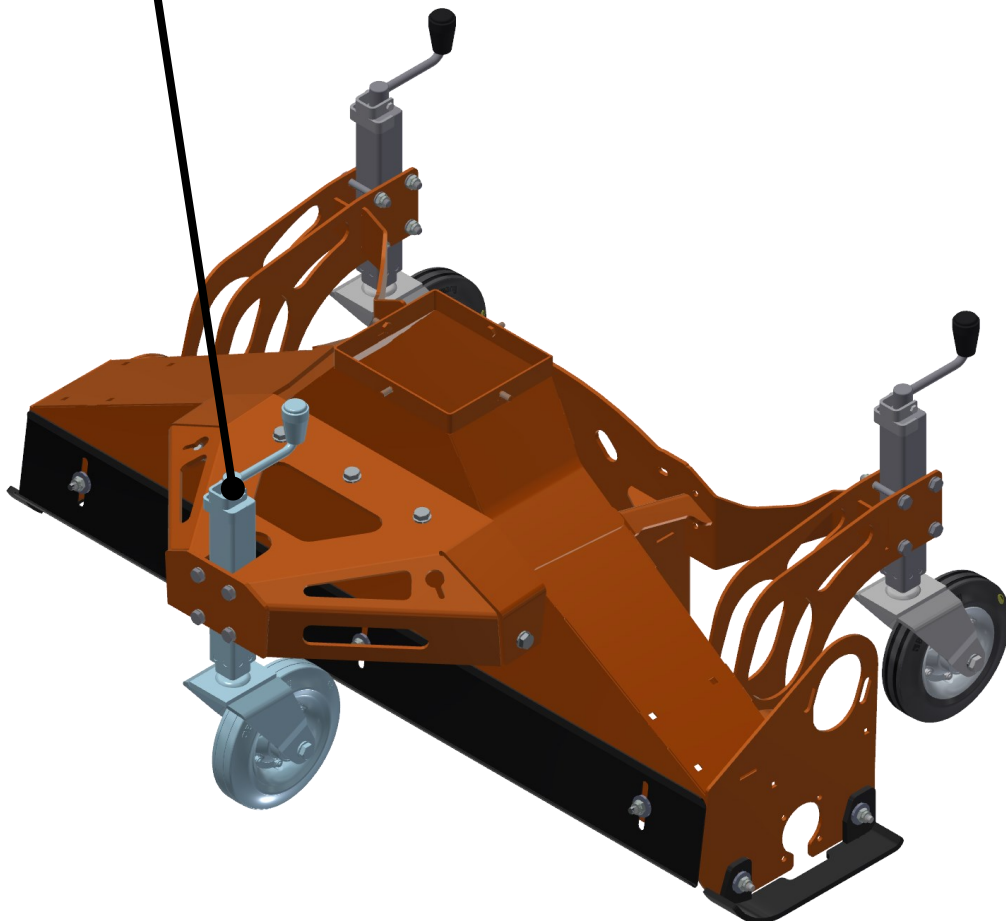
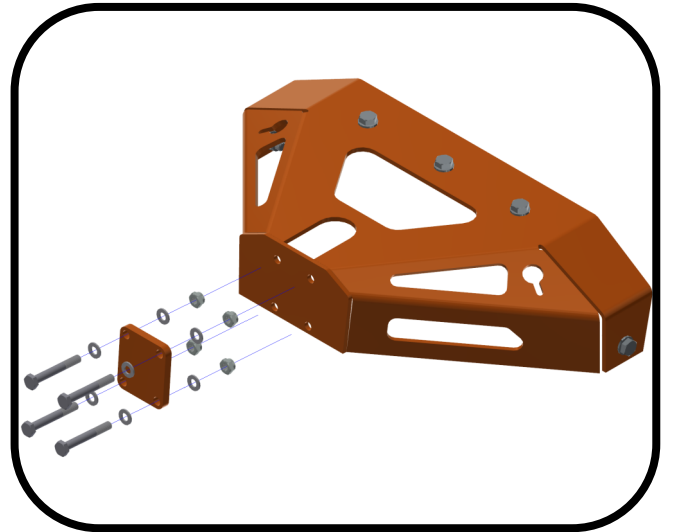

7

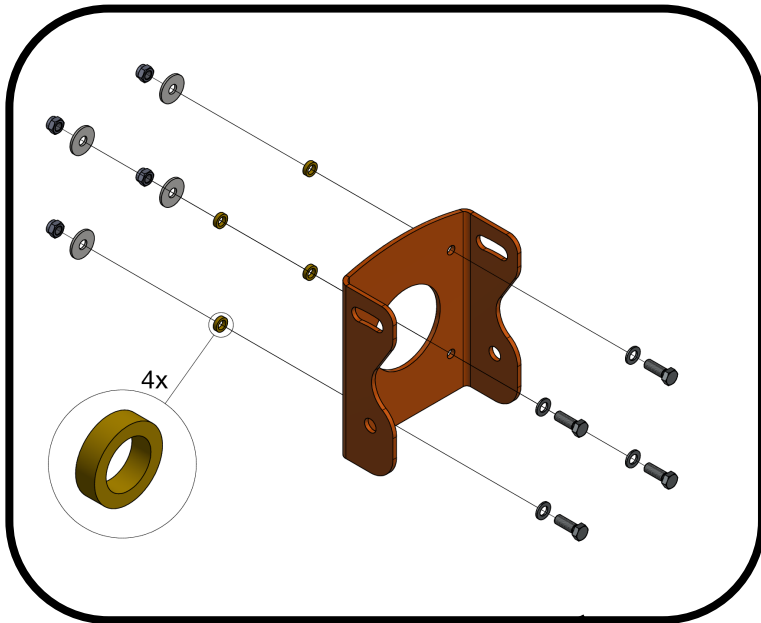

- 4x DIN 933-M16x45
- 4x DIN 985-M16
- 4x DIN 125-A17
- 4x DIN 522-17x50x4

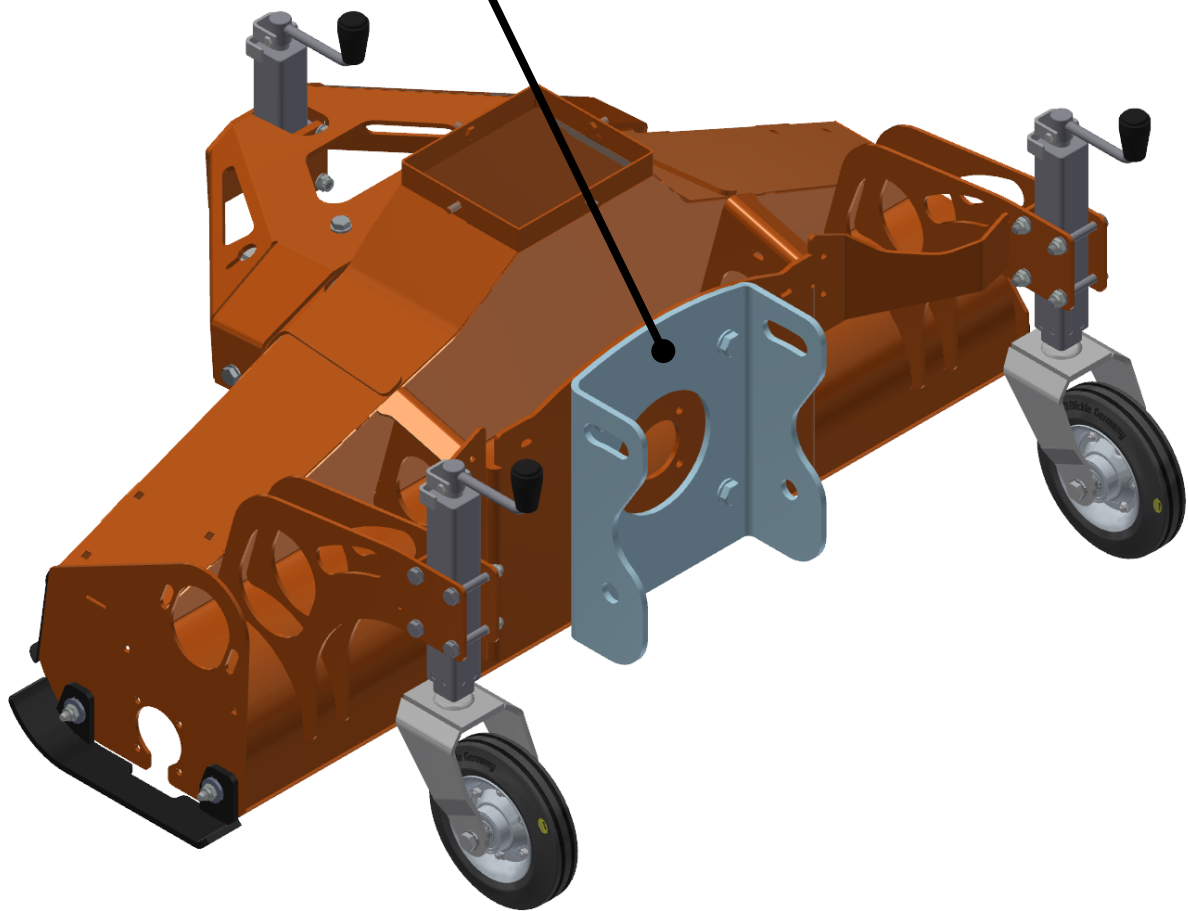

8

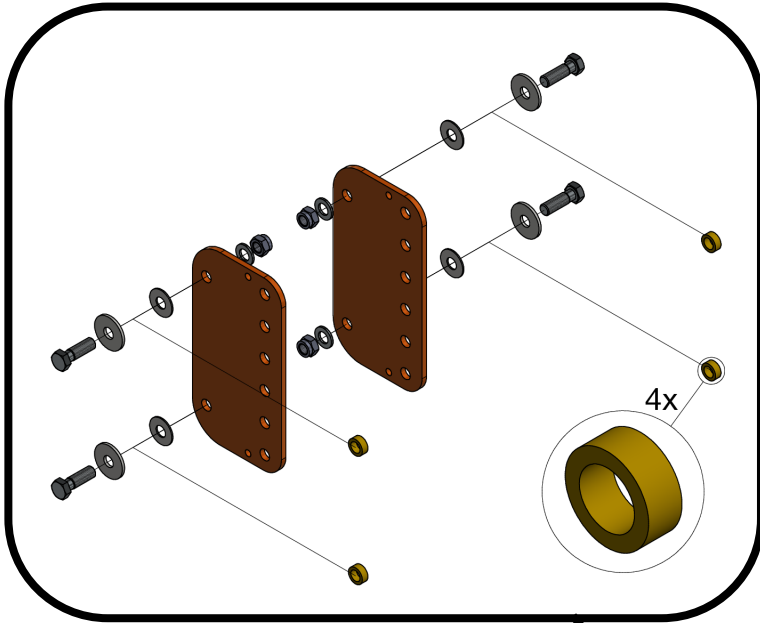

- 4x DIN 931-M16x50
- 4x DIN 985-M16
- 4x DIN 125-A17
- 4x DIN 522-17x50x4
- 4x DIN 522-17x40x2

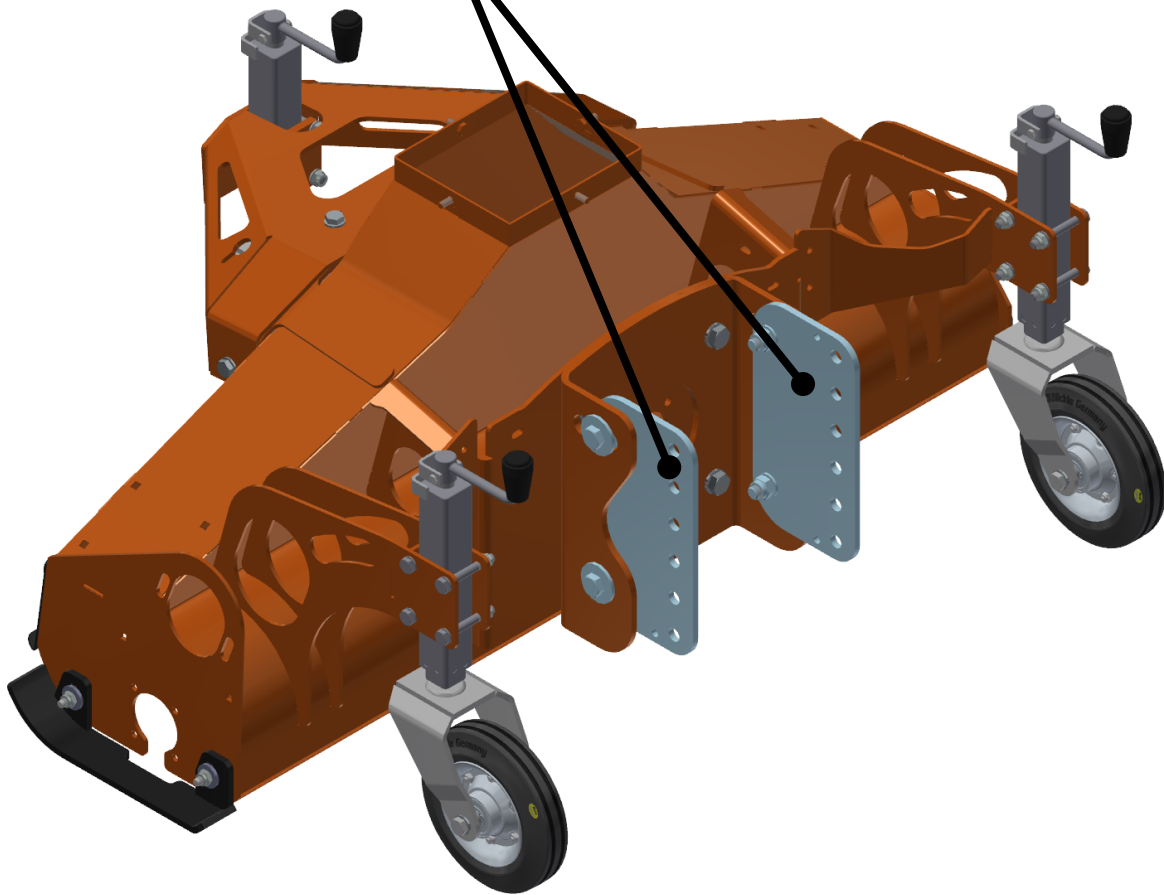

9

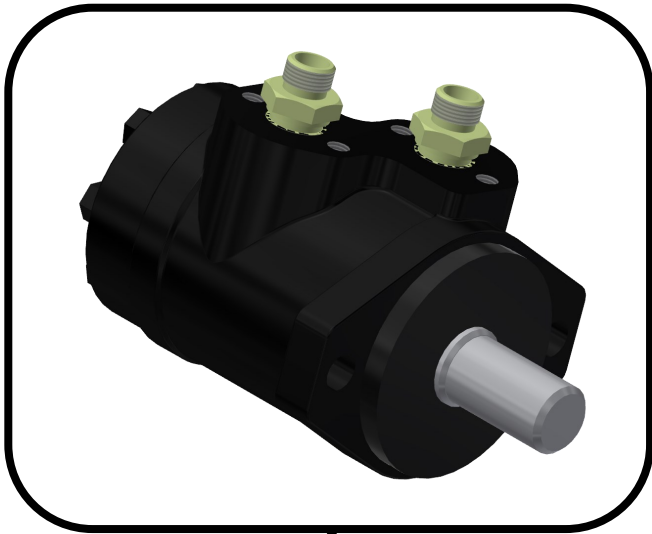

2x DIN 931-M12x45
2x DIN 985-M10
4x DIN 125-A-13

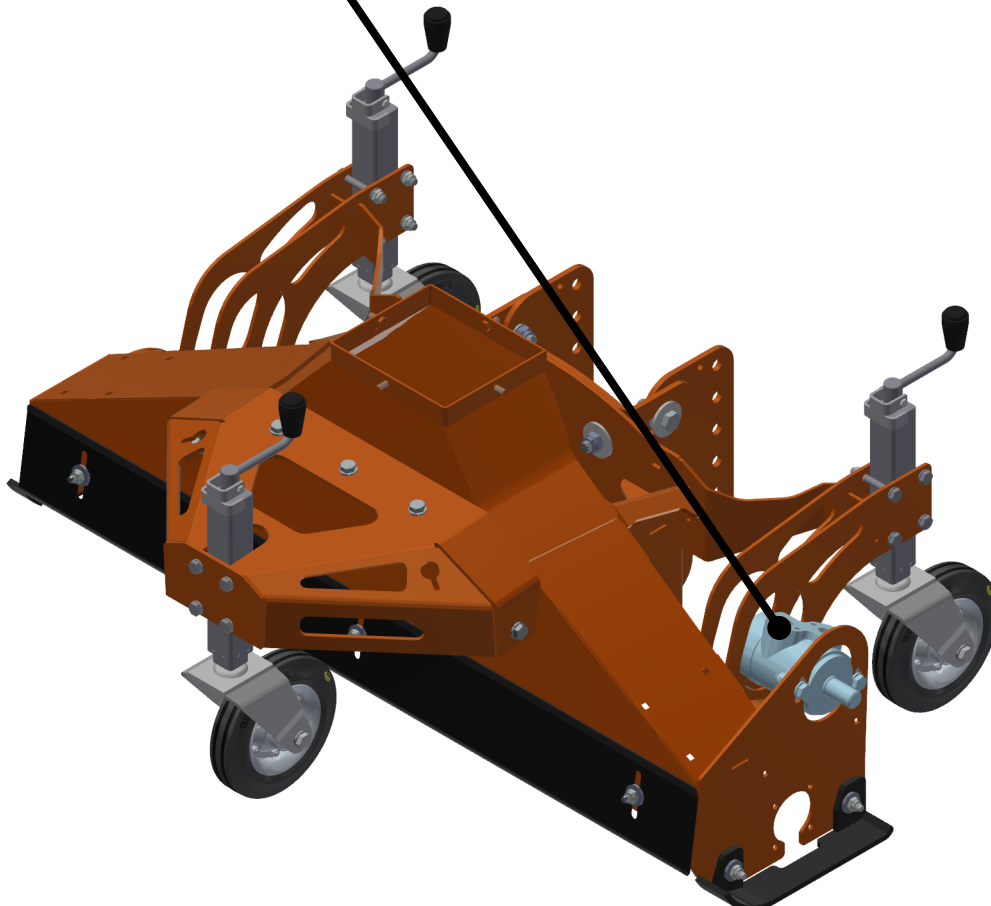
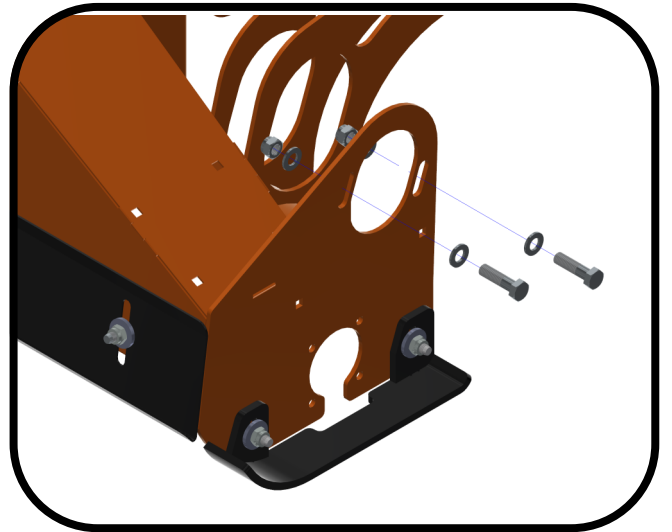

10

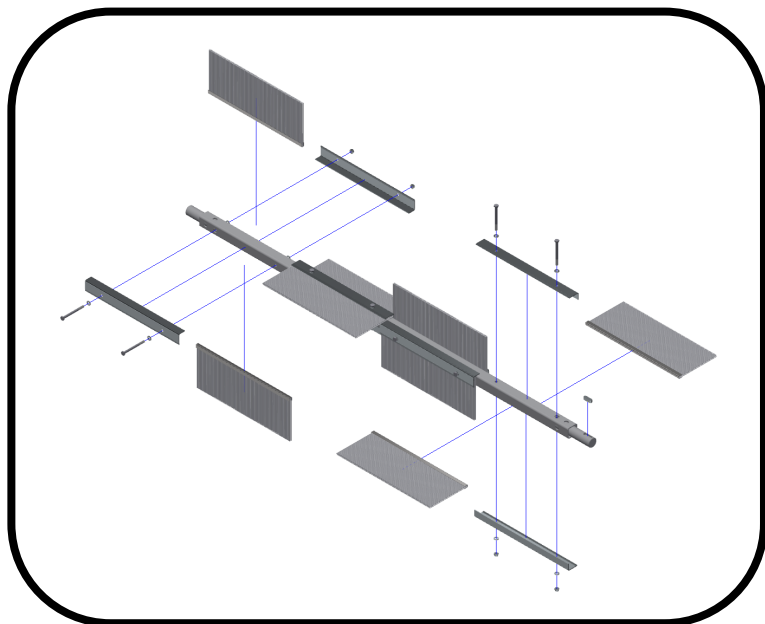

8x DIN 931-M6x65
8x DIN 985-M6
16x DIN 125-A-6.4

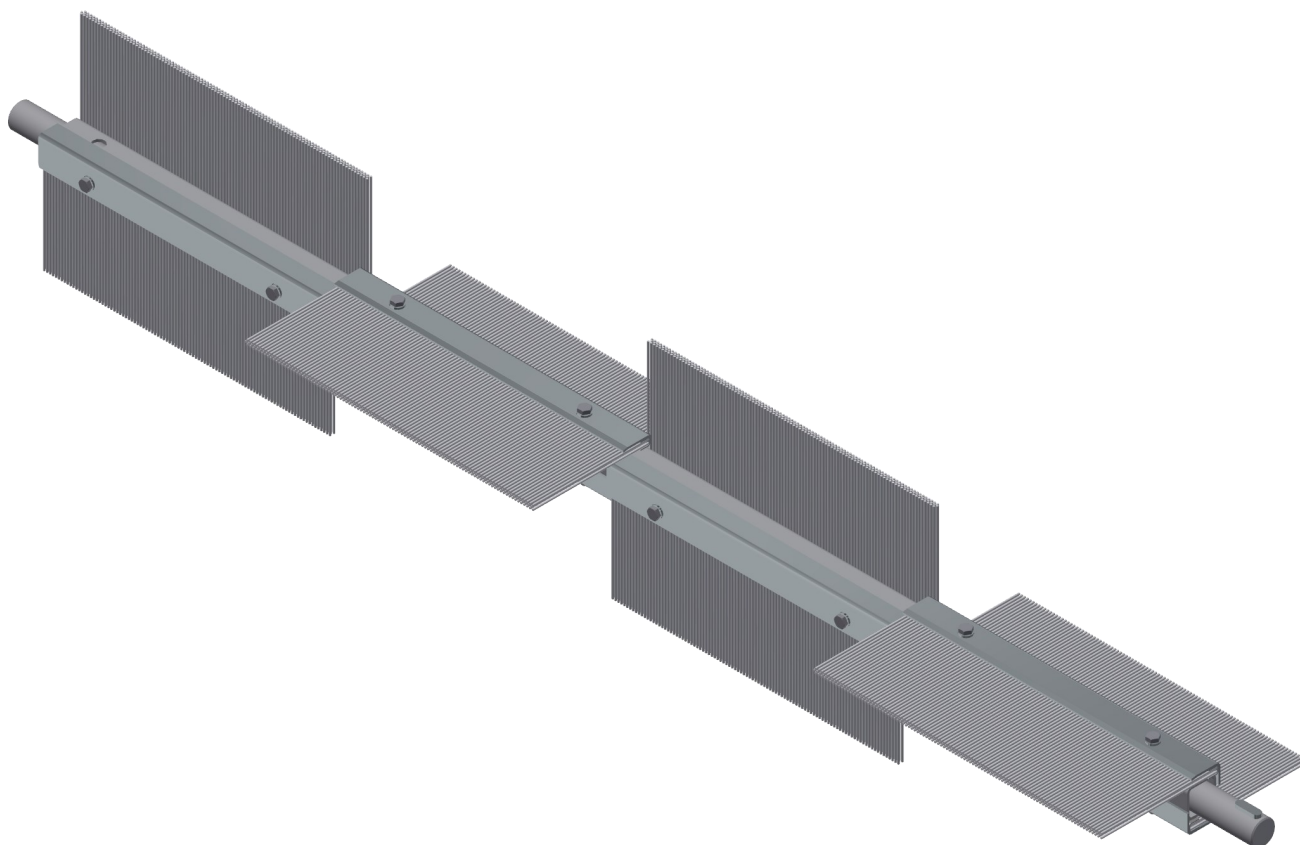

11

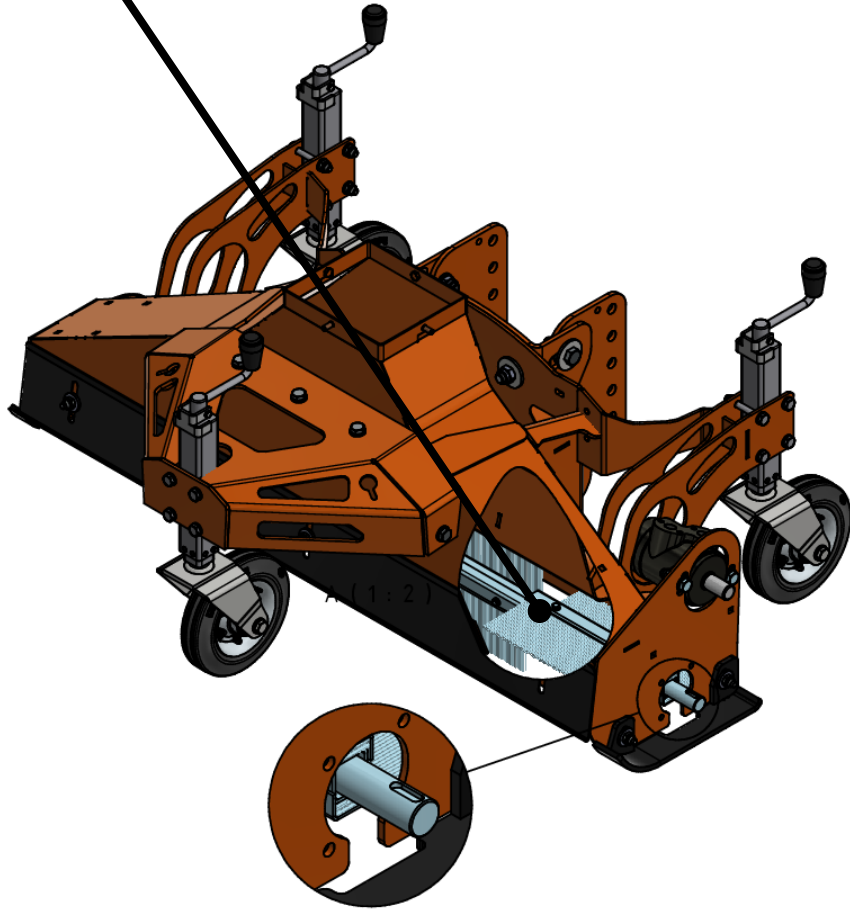
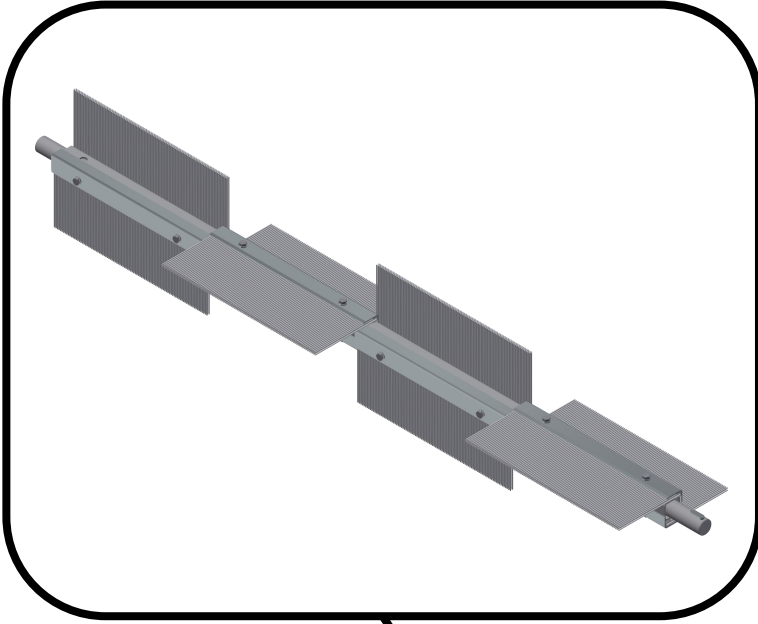

12

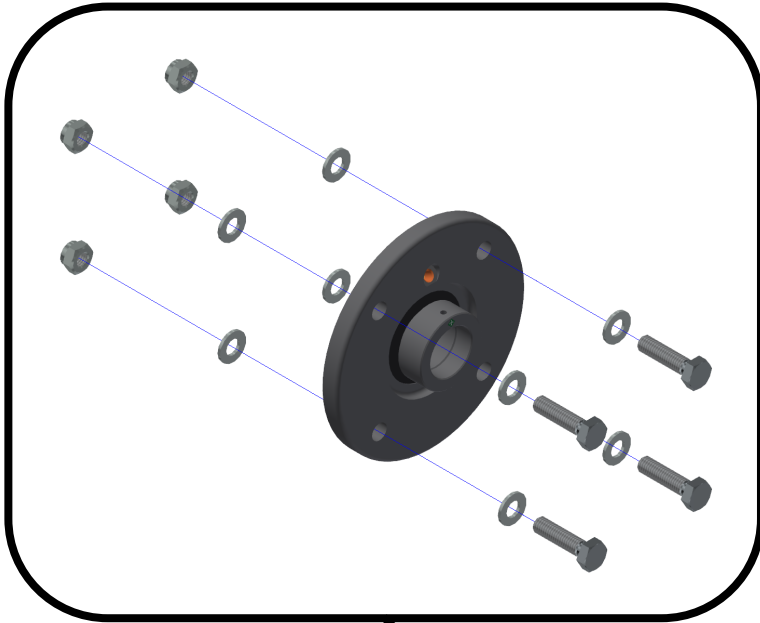

4x DIN 933-M8x30
4x DIN 985-M8
8x DIN 125-A-8.4

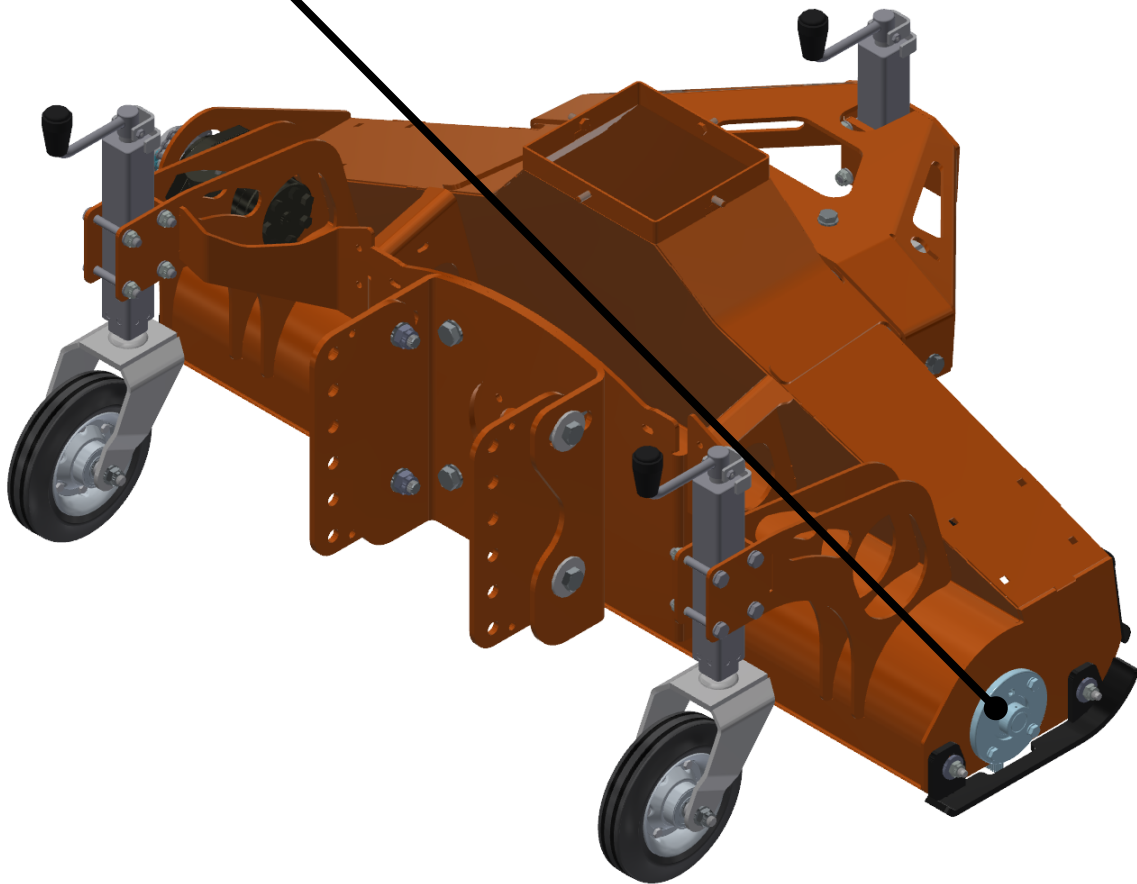

13

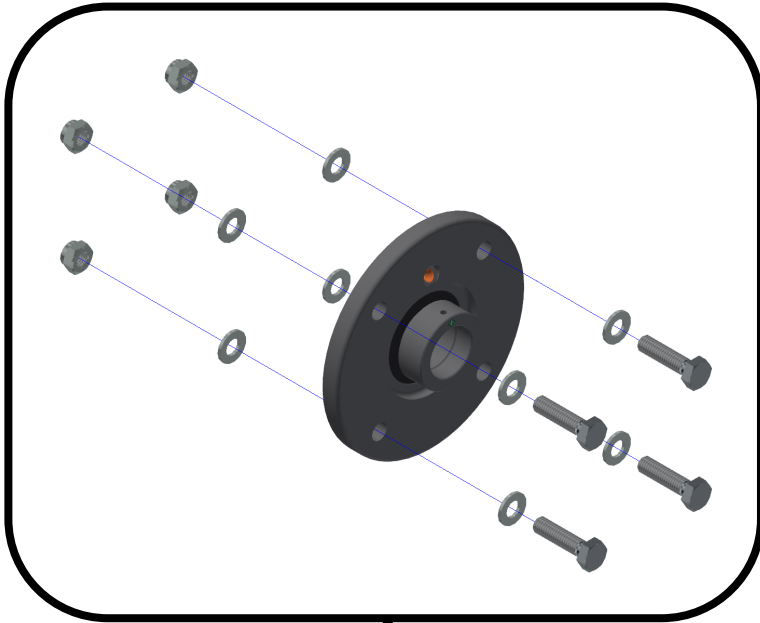

4x DIN 933-M8x30
4x DIN 985-M8
8x DIN 125-A-8.4

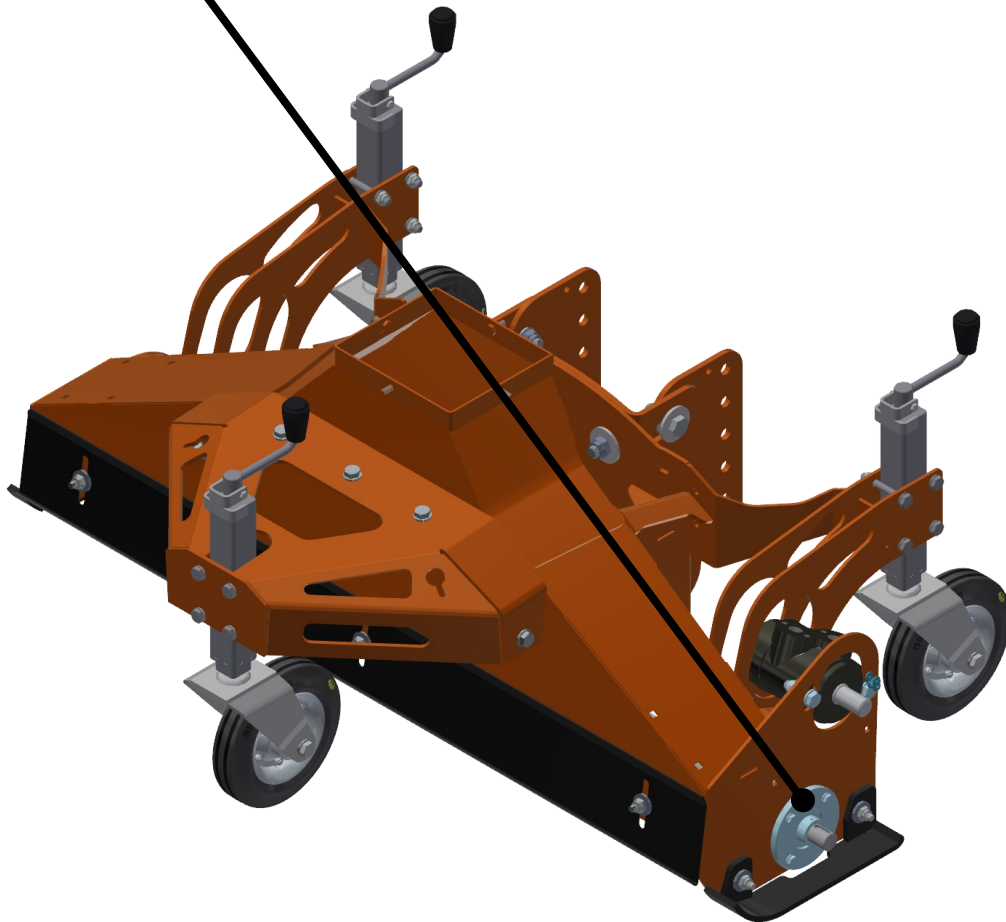

14

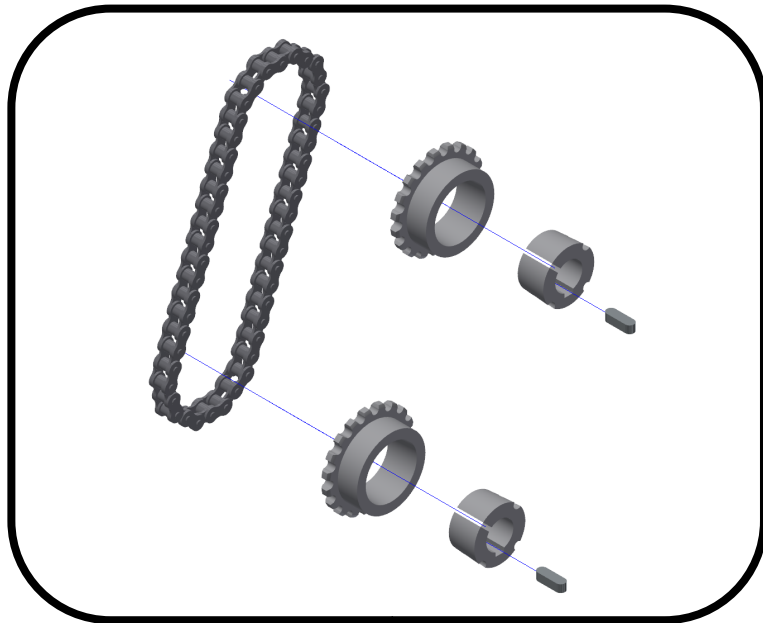

2x TP1210-25 -> 20 Nm
2x DIN 6885 -A- 8x7x25

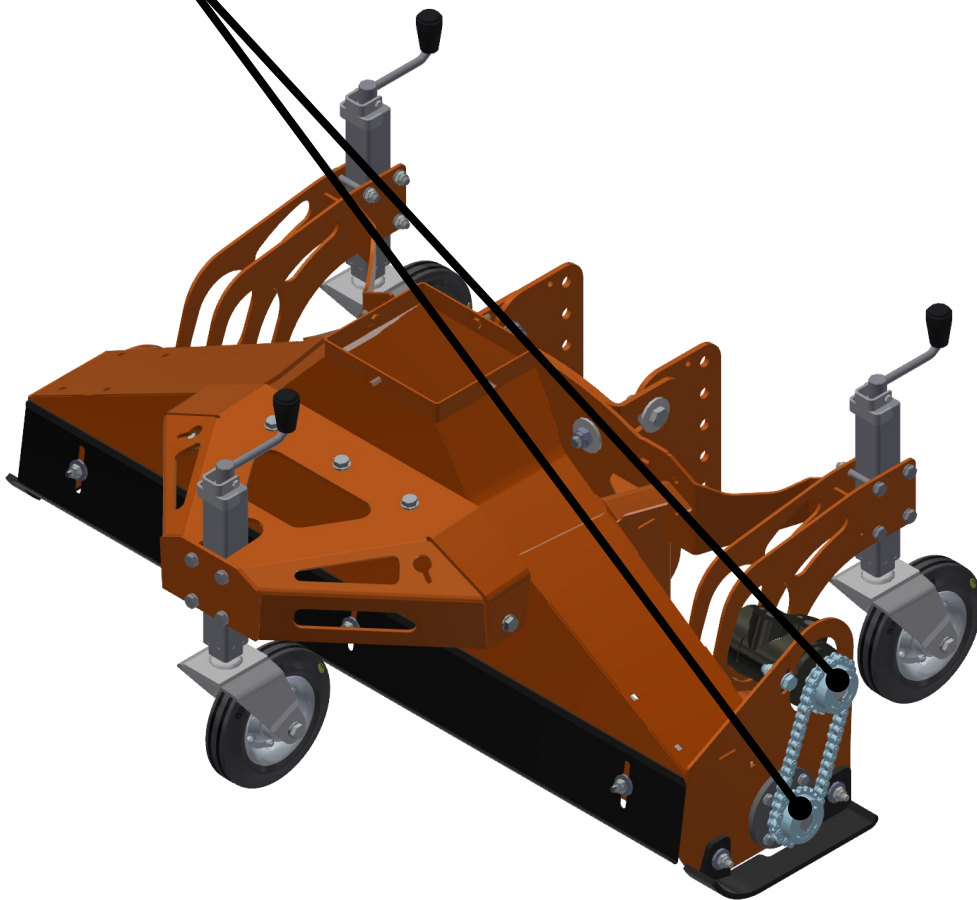

15

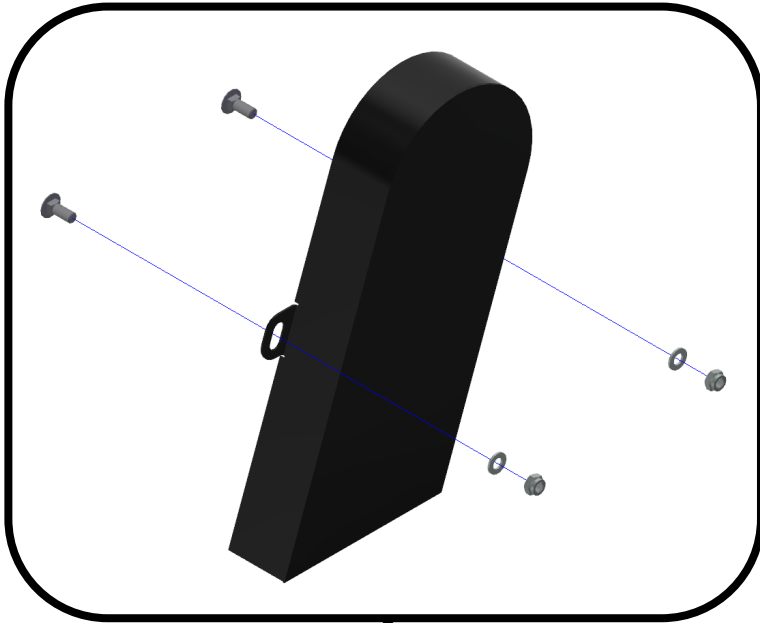

2x DIN 603 M8x20
2x DIN 985-M8
2x DIN 125-A8

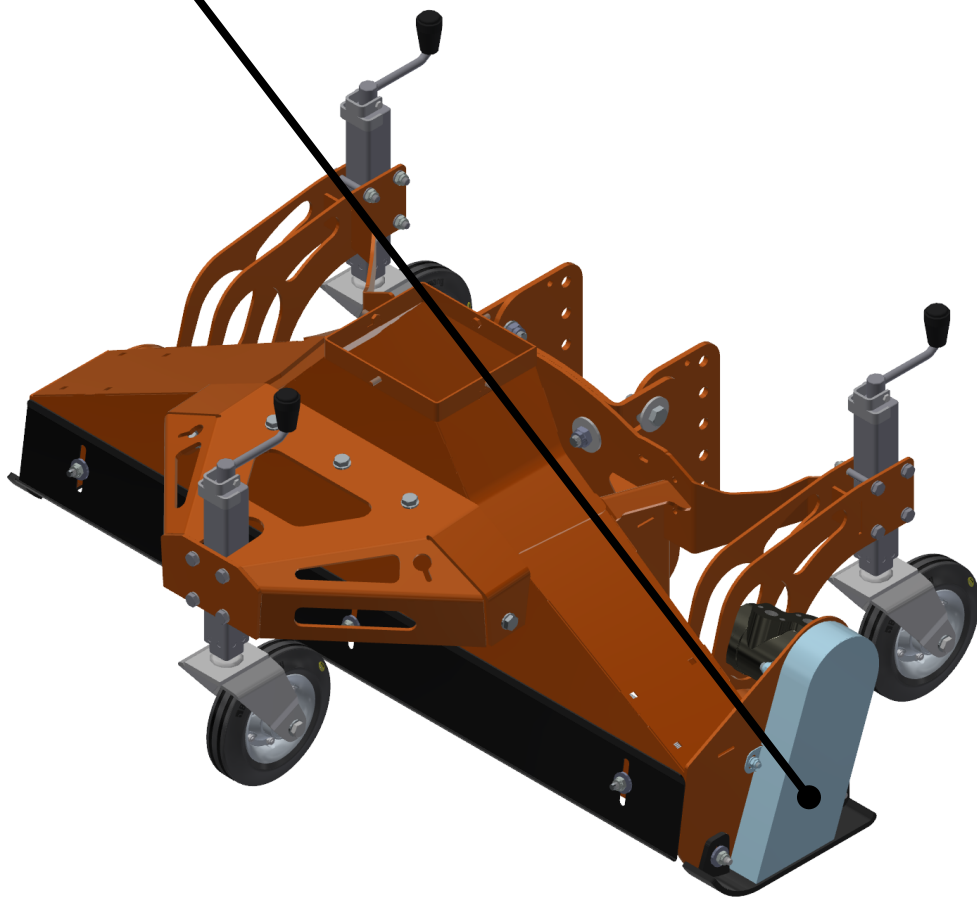

MRM

Montageanleitung Mounting assembly

Saugstutzen Ø200
suction socket

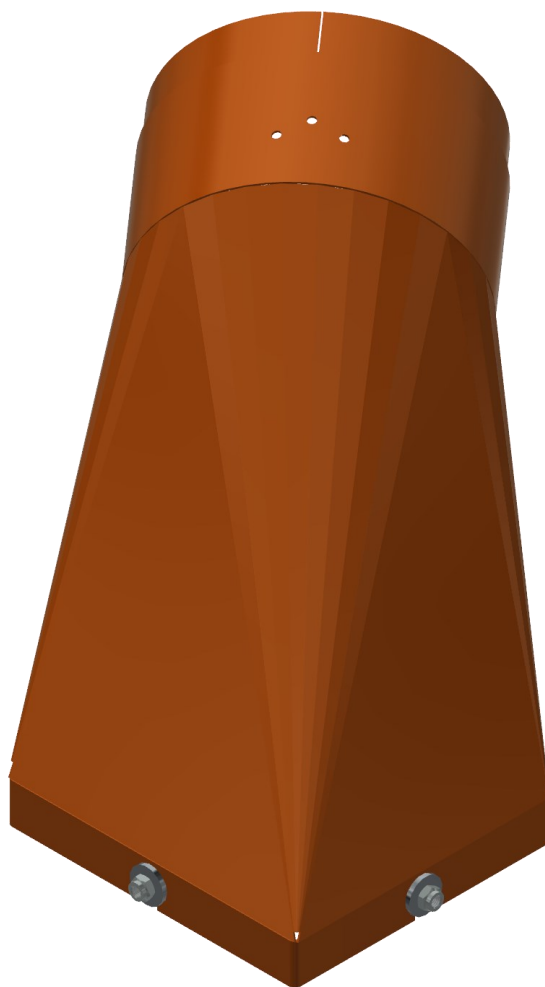

1

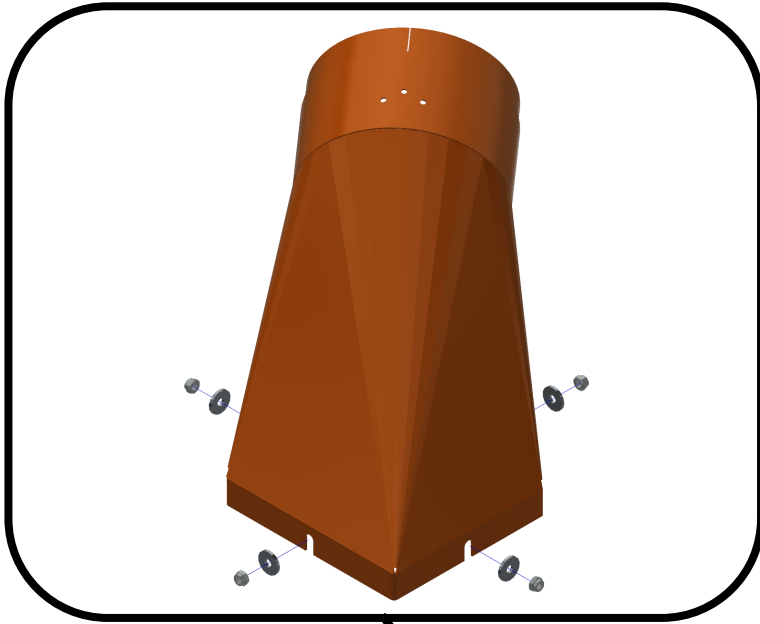

4x DIN 985-M8
4x DIN 522-8,5x25x3

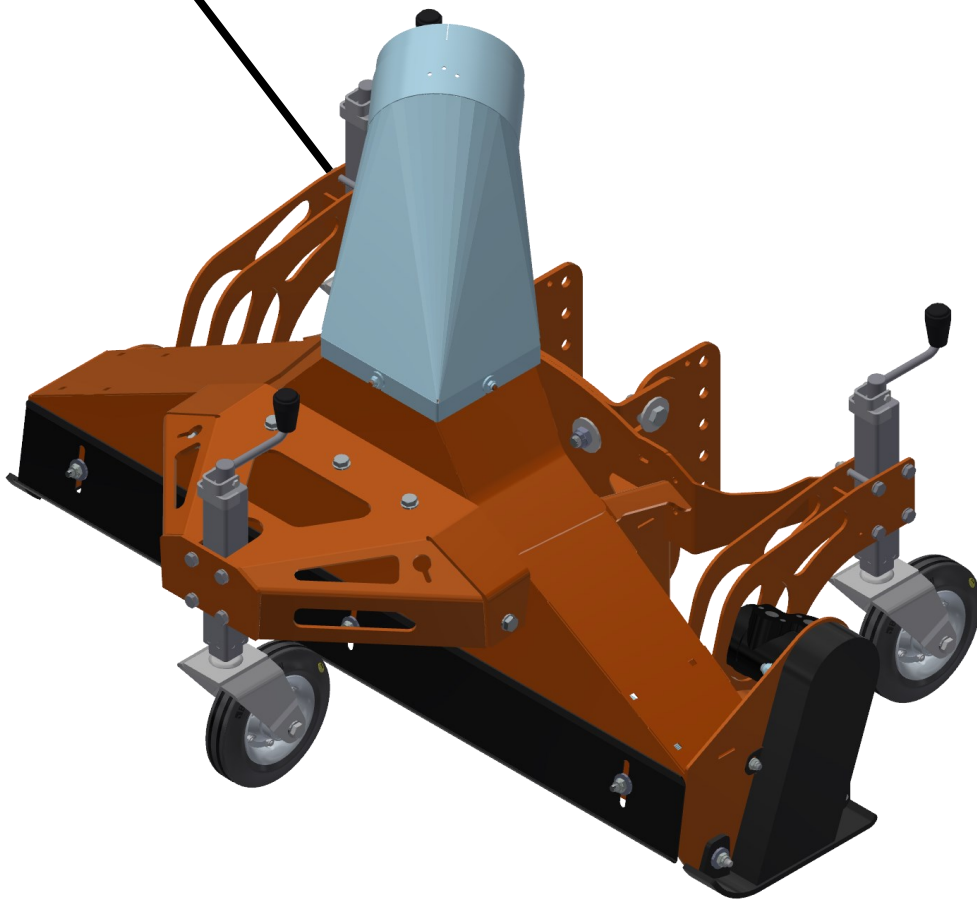

MRM Aktive Absaugung active suction

Montageanleitung Mounting assembly

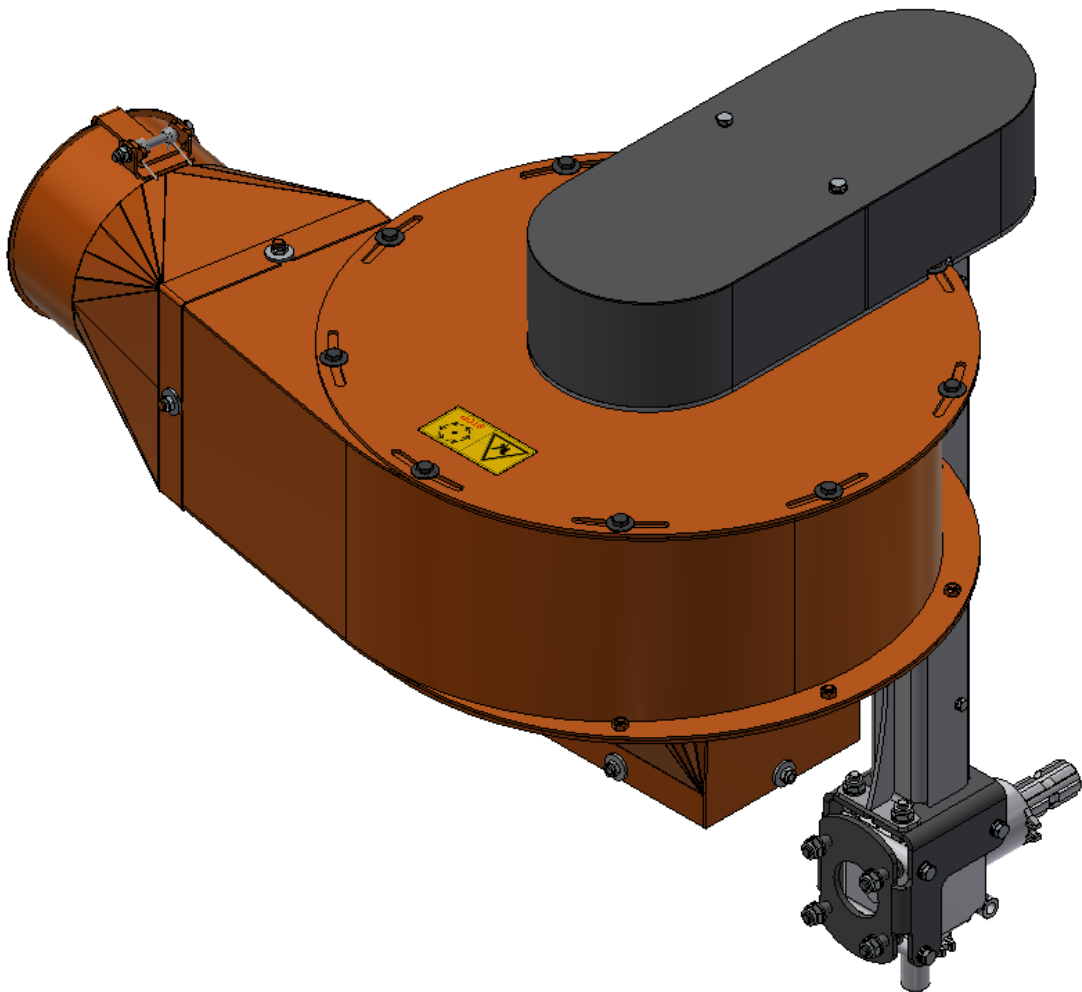

1

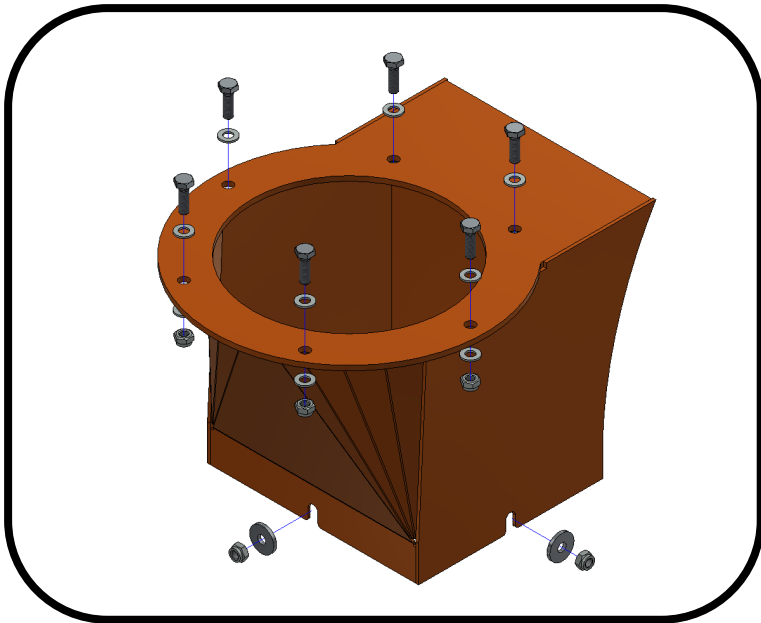

6x DIN 933 M8x25
12x DIN 125
6x DIN 985

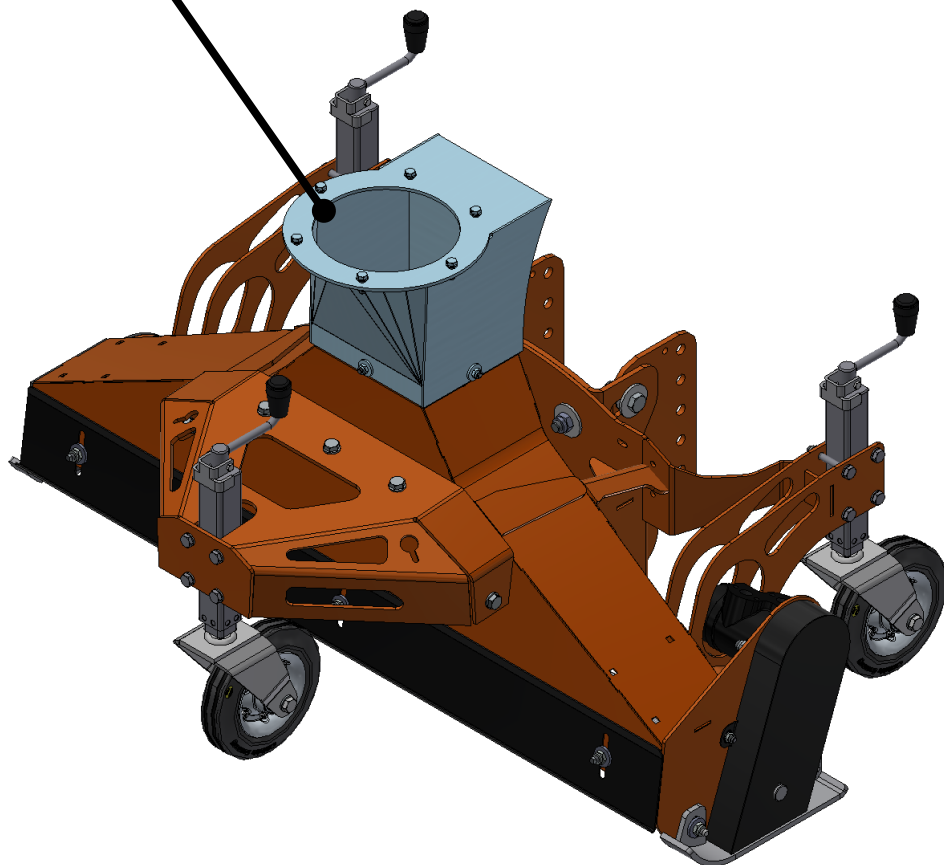

2

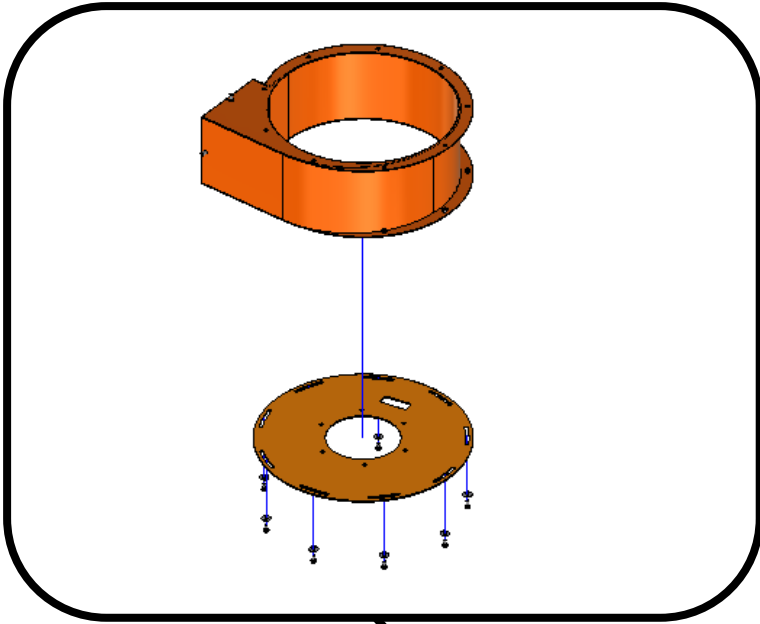

9x DIN 933 M8x16
9x DIN 522

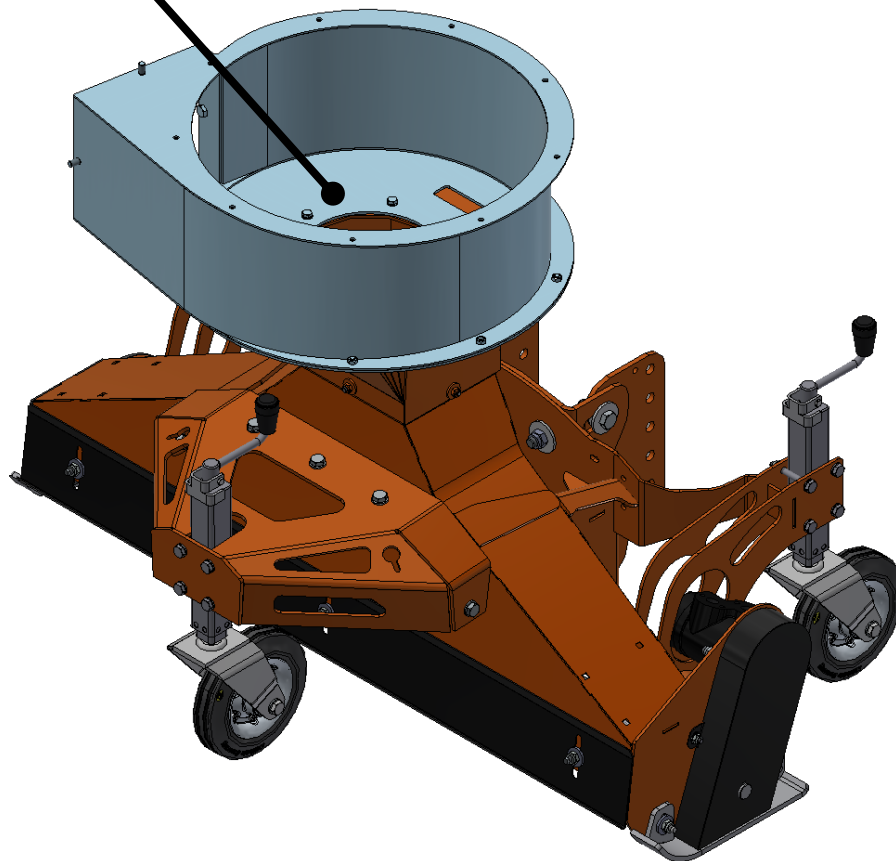

3

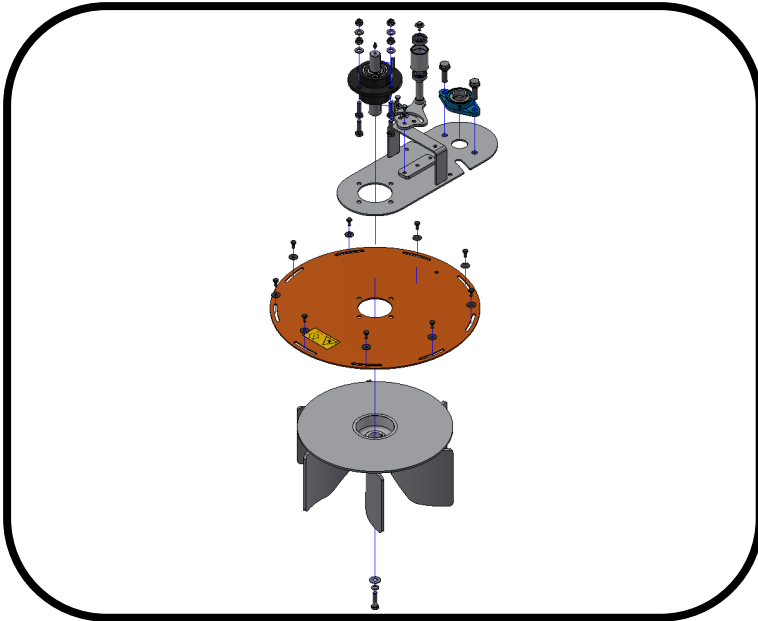

- 9x DIN 933 M8x16
- 9x DIN 522 8,4x20x1,25
- 4x DIN 933 M12x40
- 4x DIN 125 A12
- 4x DIN 985-12
- 2x DIN 931 M16x50
- 2x DIN 125 A16
- 1x DIN 933 M8x20
- 1x DIN 127 A8
- 1x DIN 522 8,5x25x1,25
- 2x DIN 933-M10x20-8.8
- 2x DIN 127-A-10
- 2x DIN 522-10,5x30x1,5

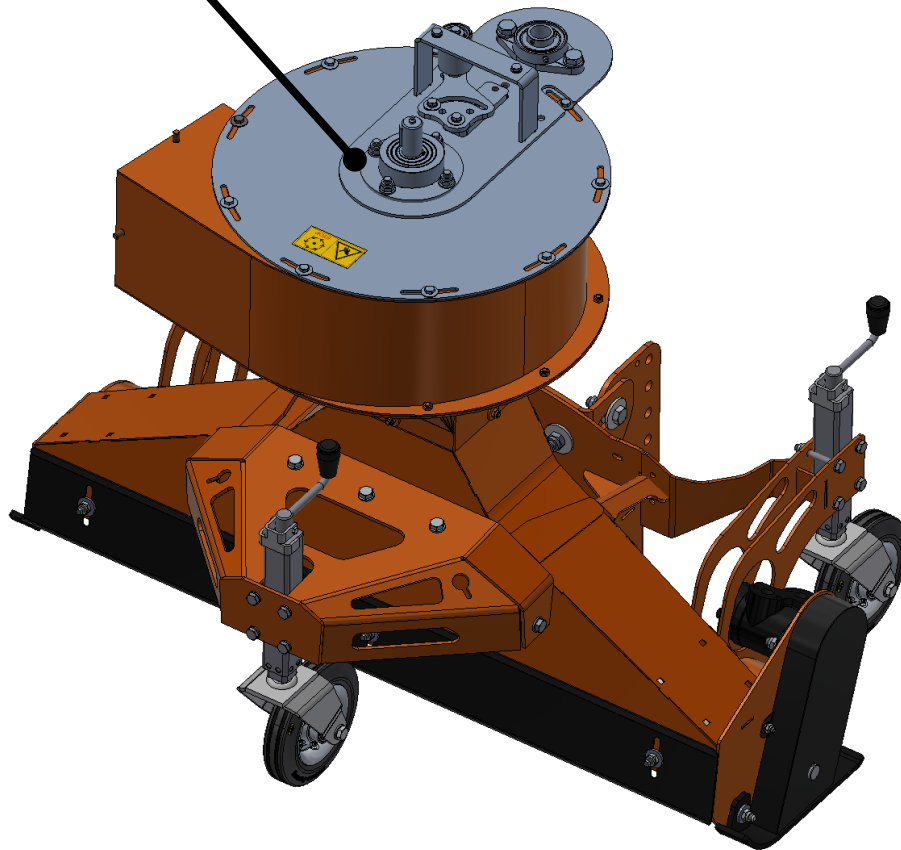

4

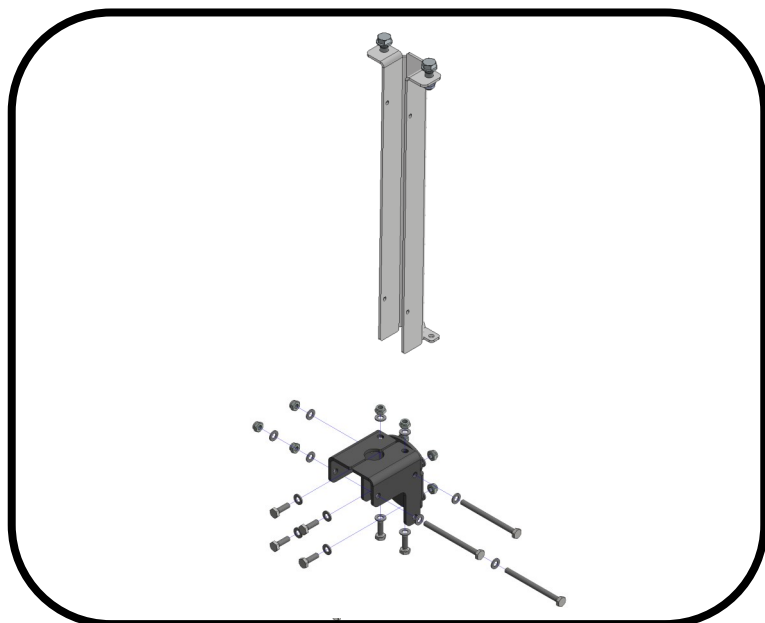

3x DIN 933-M10x130-8.8
18 x DIN 125 -A-10
6 x DIN 933 M10x30
9 x DIN 985 M10

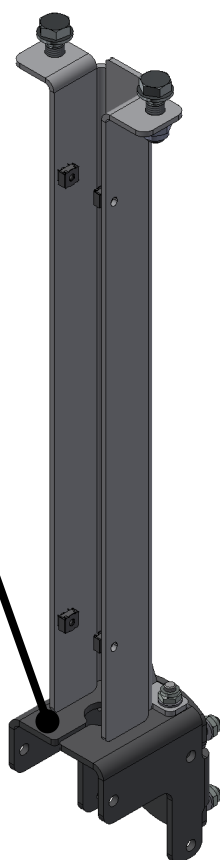

4a

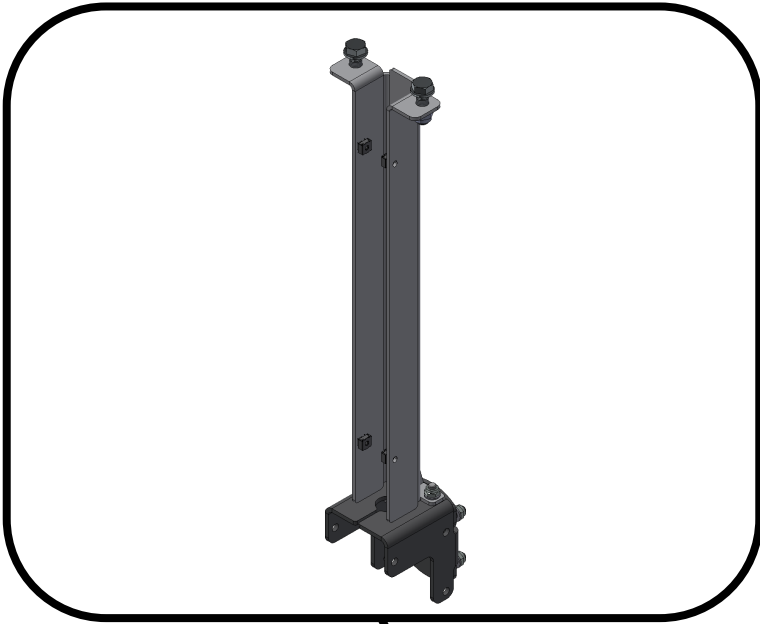

4x DIN 933 M10x30
8x DIN125 10,5

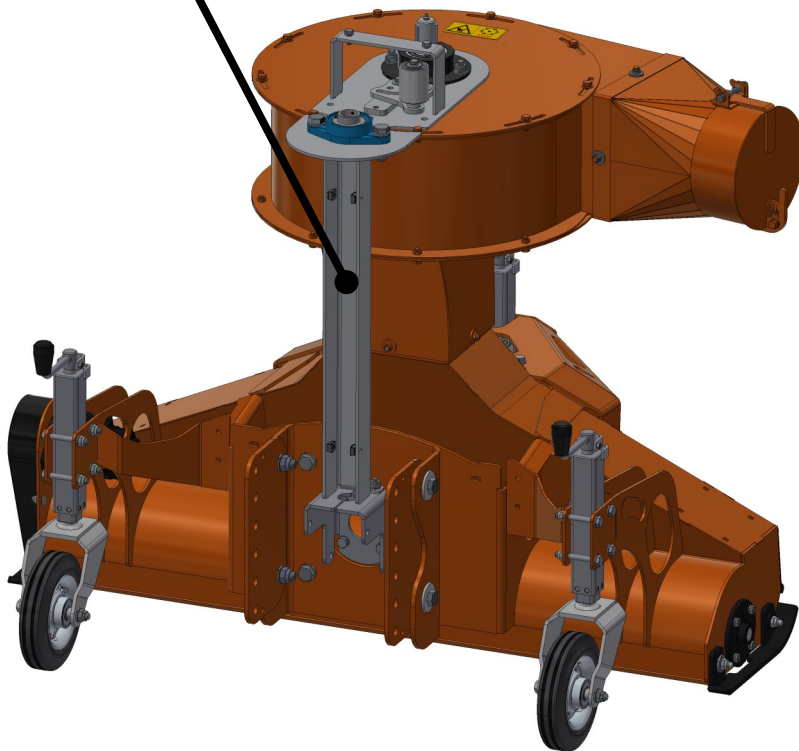

4b

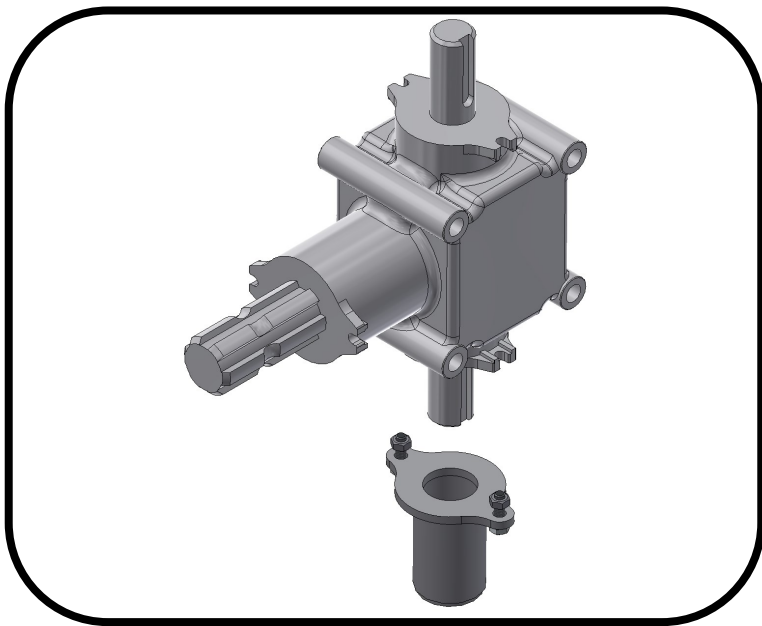

3 x DIN 933 M10x130

6 x DIN 125 A-10

3 x DIN 985-M10-8.8

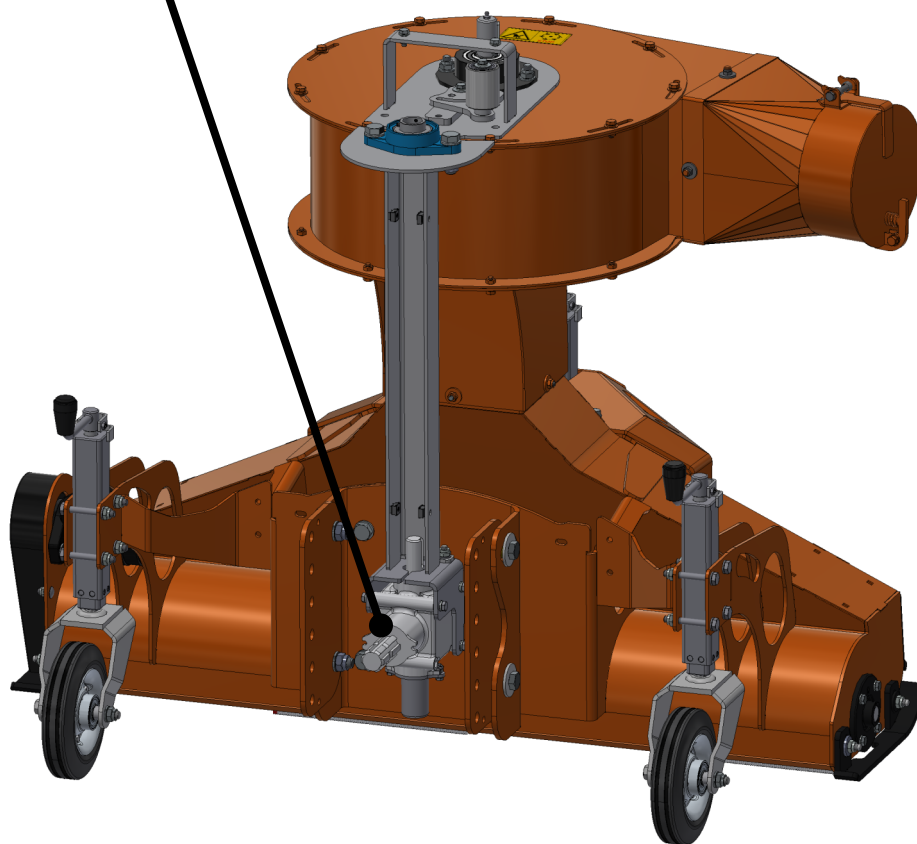

5

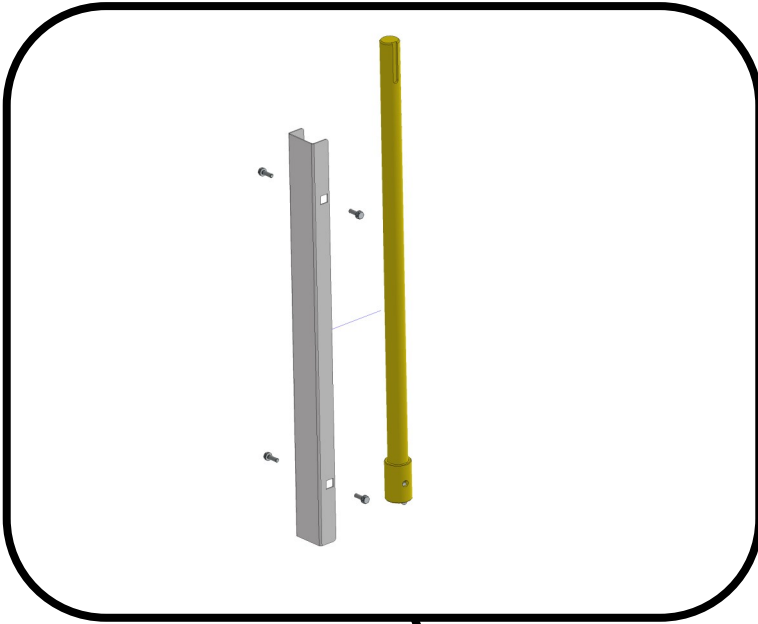

4x DIN 933 M6x20
4x DIN 125 A6,4
4x M6-4-12,3x12,3
1x DIN 6885-A-8x7x25

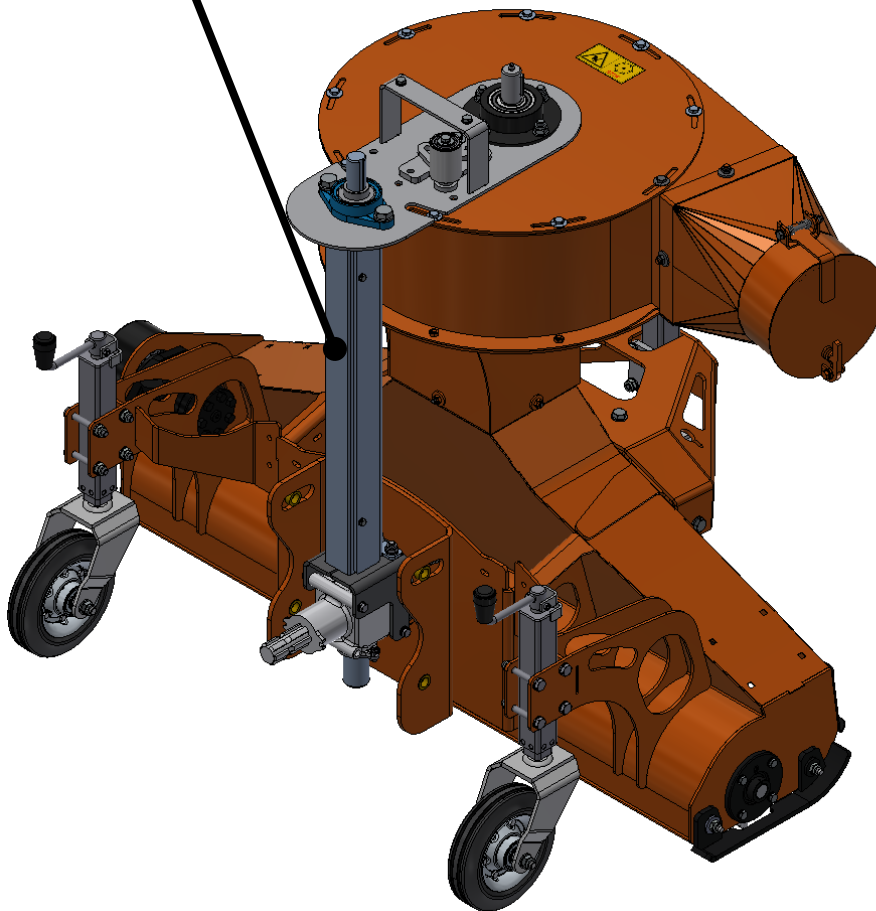

6

2000 U/min

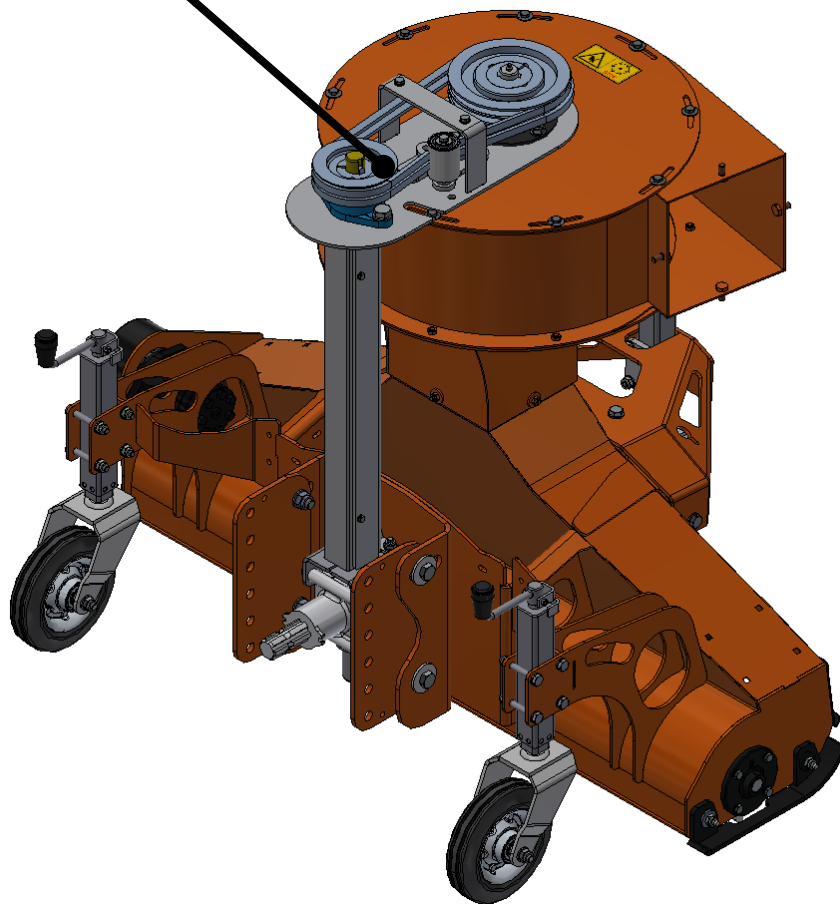
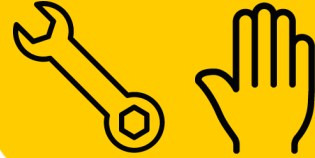
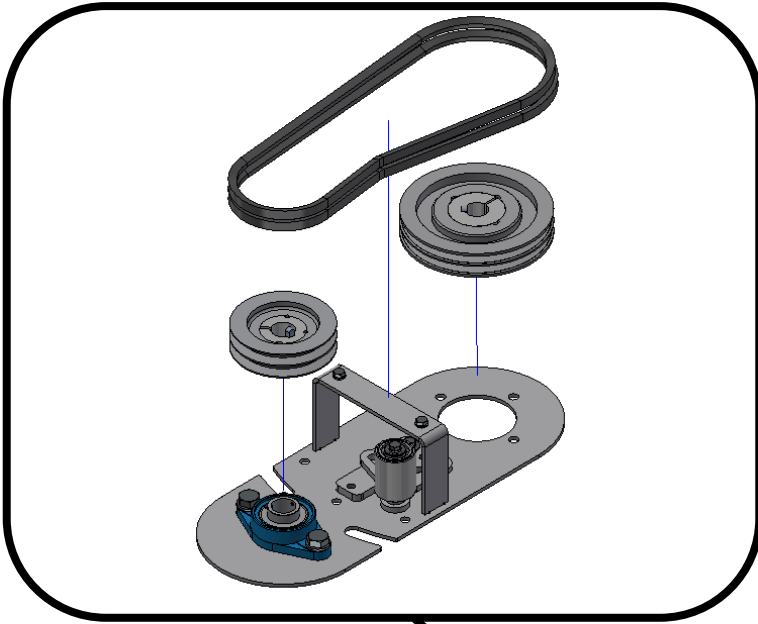

6b

1000U/min

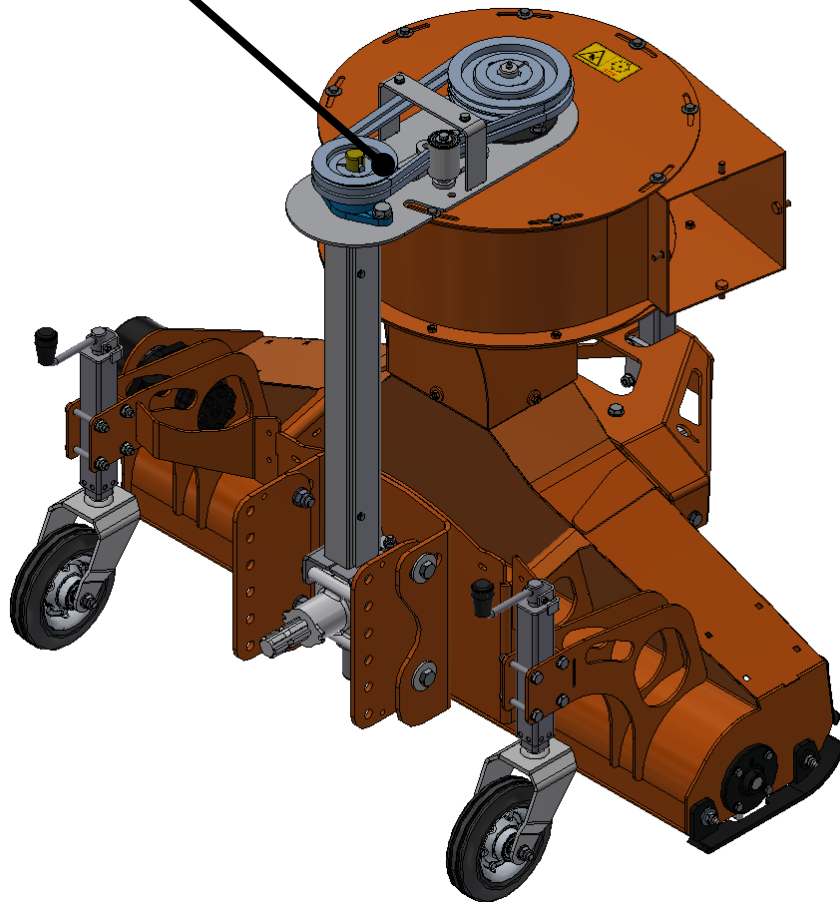
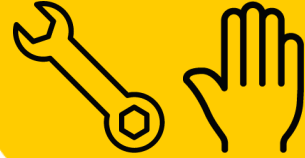
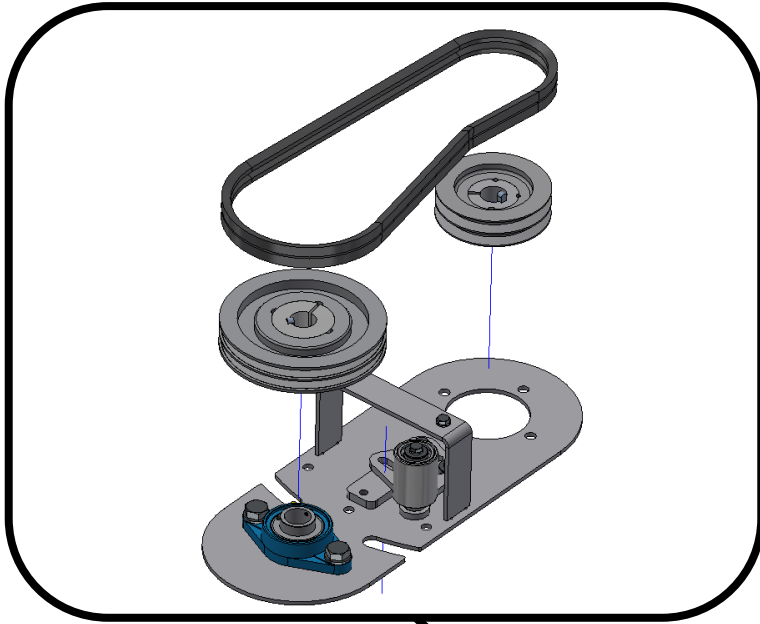

7

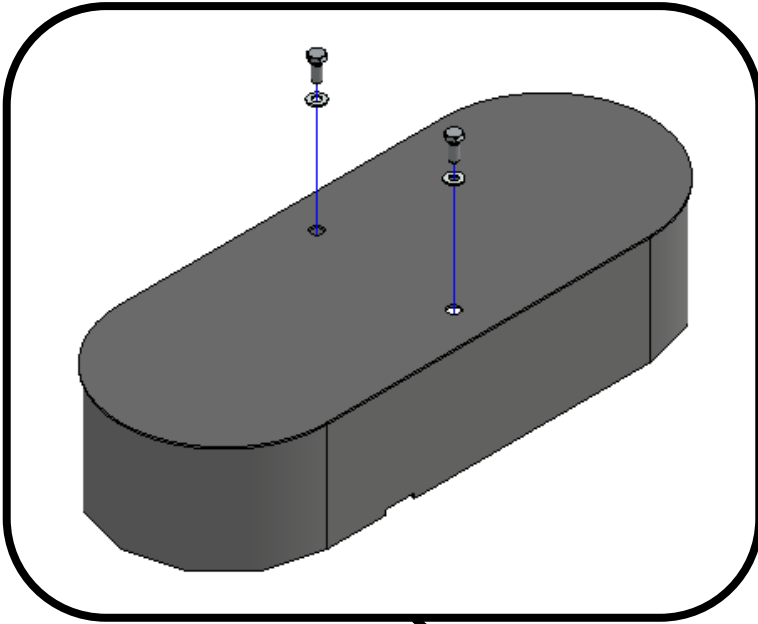

2x DIN 933 M8x20
2x DIN 125 A8

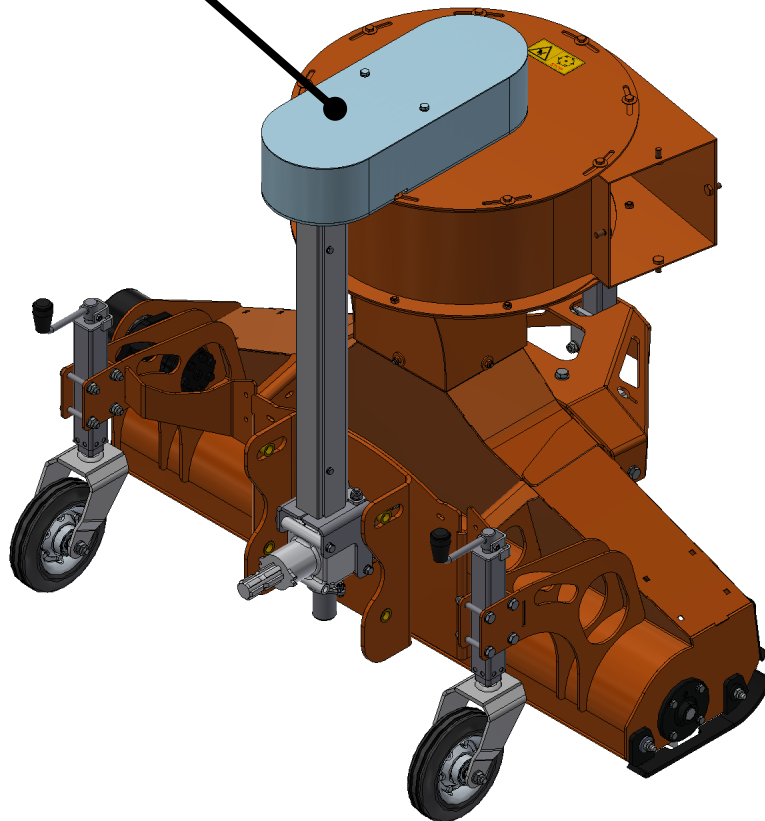

8

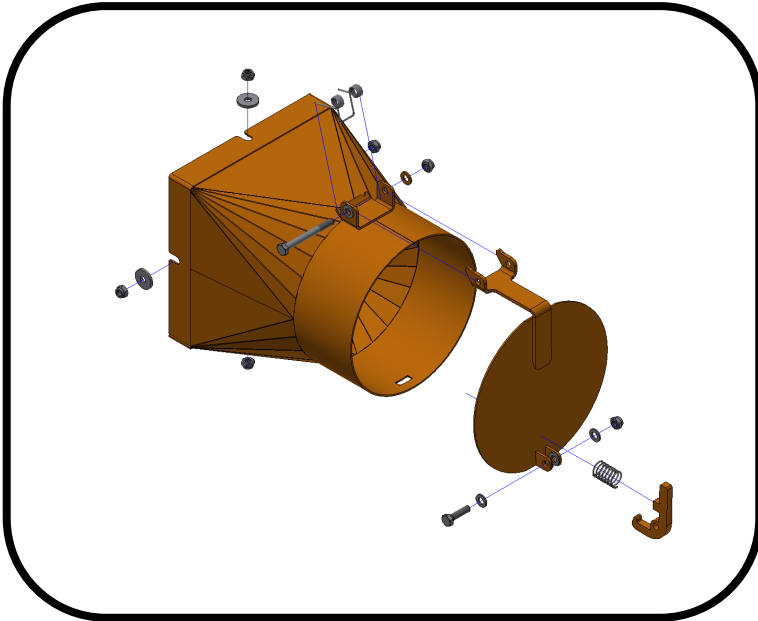

- 1x DIN 931 M8x75
- 6x DIN 125 A8
- 5x DIN 985 M8
- 4x DIN 522 8,5
- 1x DIN 933 M8x30

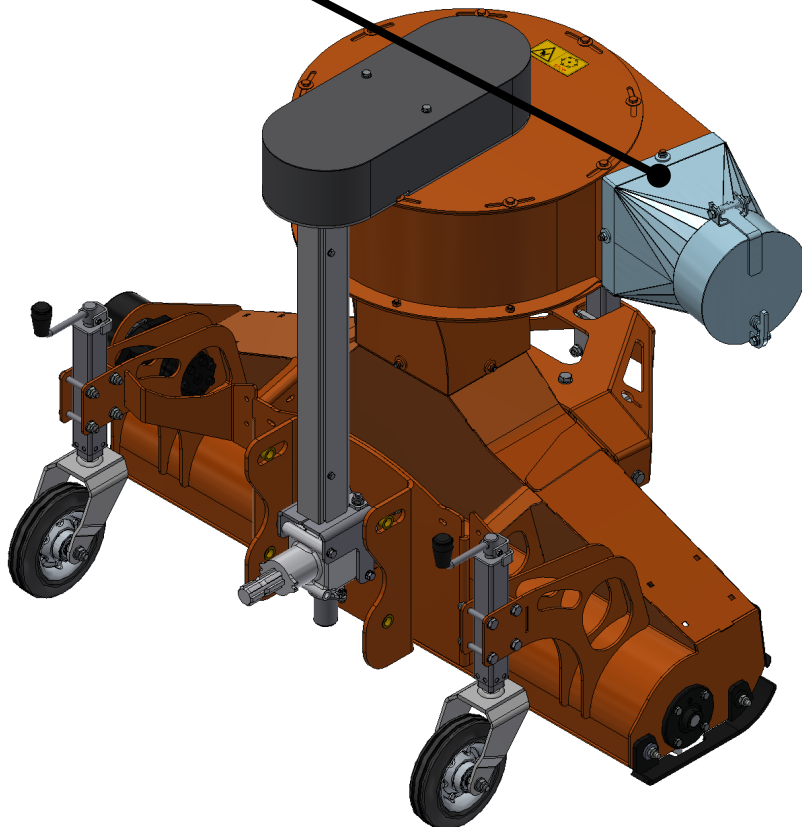

MRM **Seitenbesen** **side broom**

Montageanleitung Mounting assembly

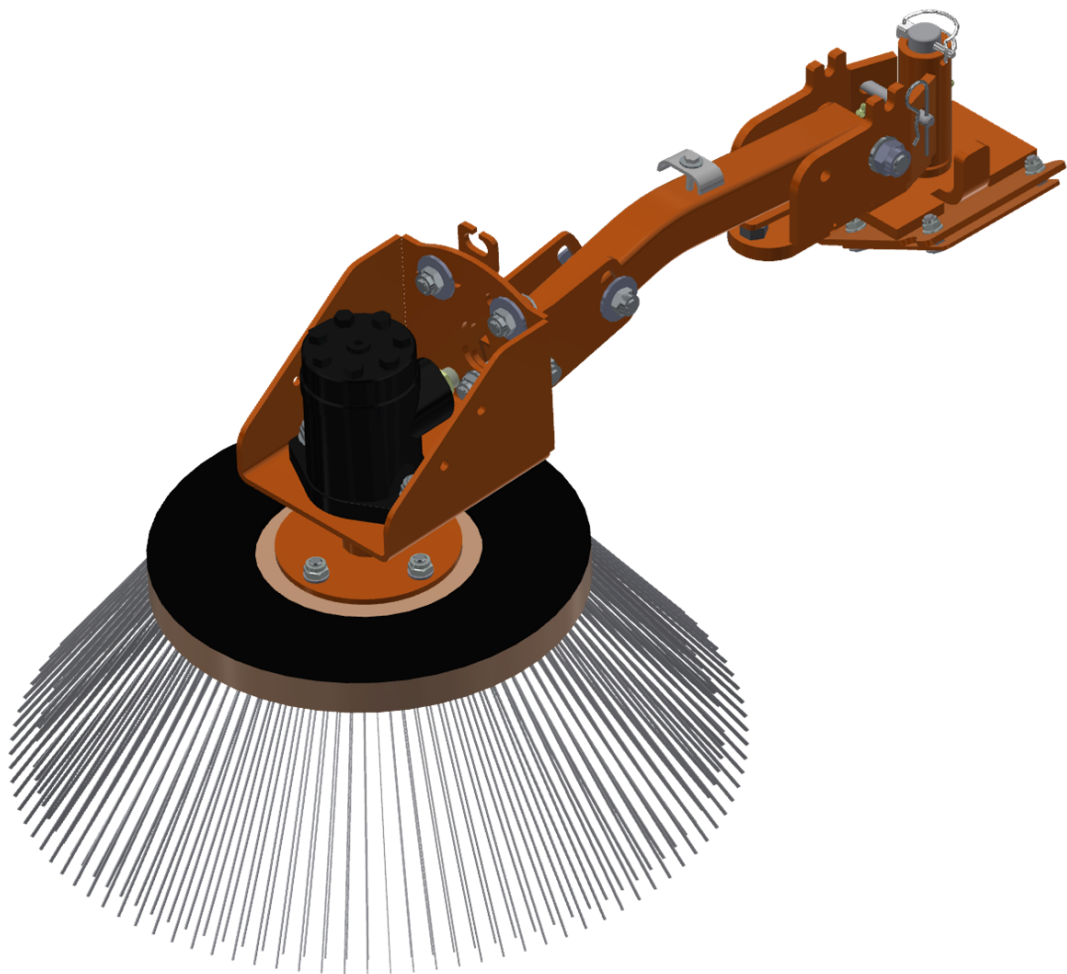

1

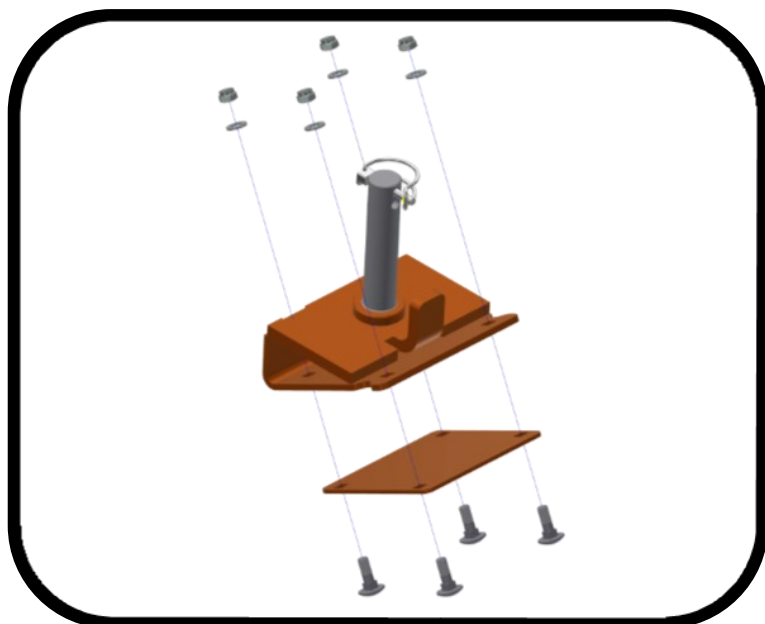

4x DIN 603-M8x25
4x DIN 985-M8
4x DIN 125-A8.4

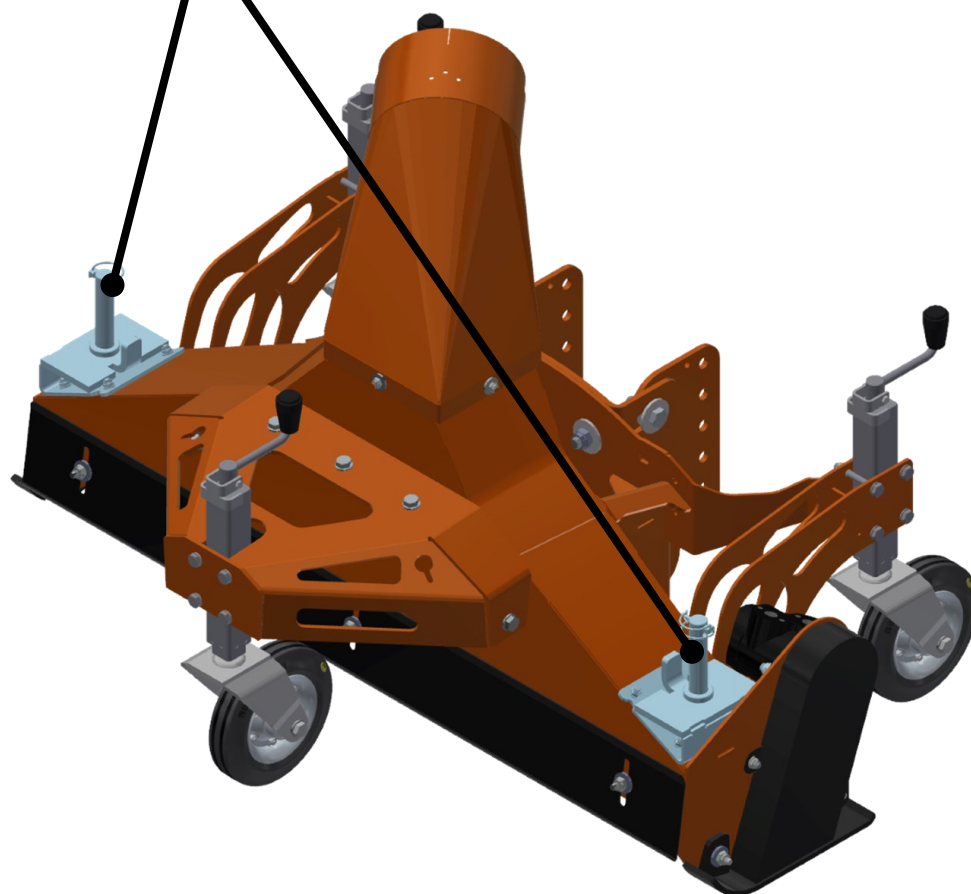

2

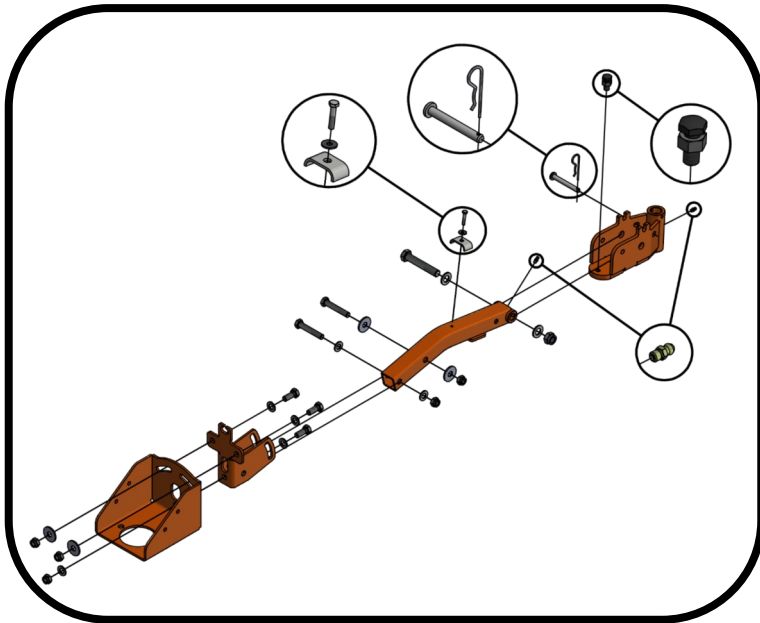

- 1x DIN 931-M16x95
- 2x DIN 931-M12x70
- 1x DIN 931-M6x30
- 3x DIN 933-M12x30
- 1x DIN 985-M16
- 5x DIN 985-M12
- 2x DIN 125-A17
- 6x DIN-125-A13
- 4x DIN 9021-13x37x3
- 1x DIN 9021-6.4x18x1.6

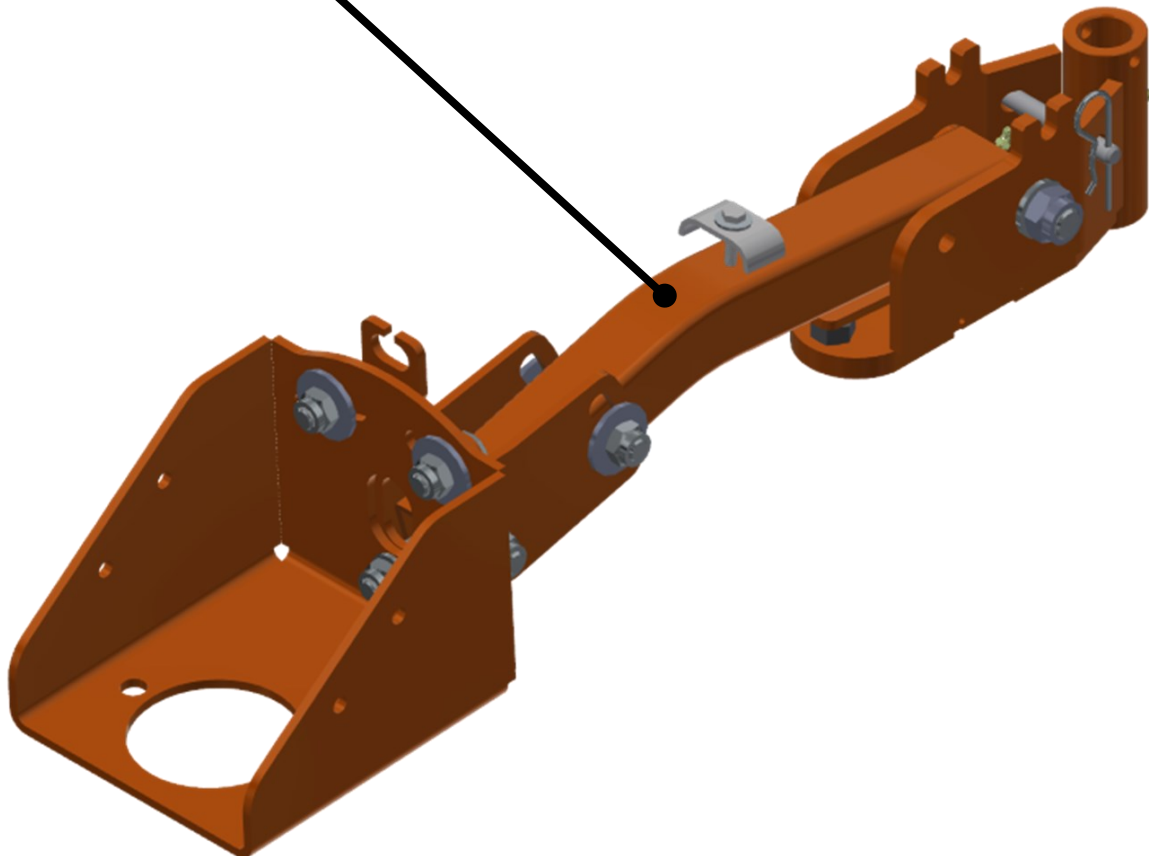

3

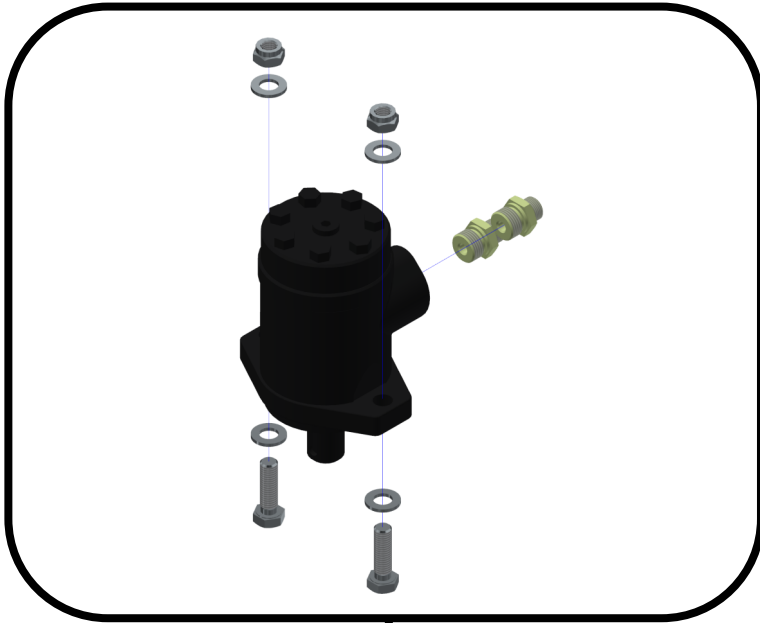

2x DIN 933-M12x40

2x DIN 985-M12

4x DIN 125-A13

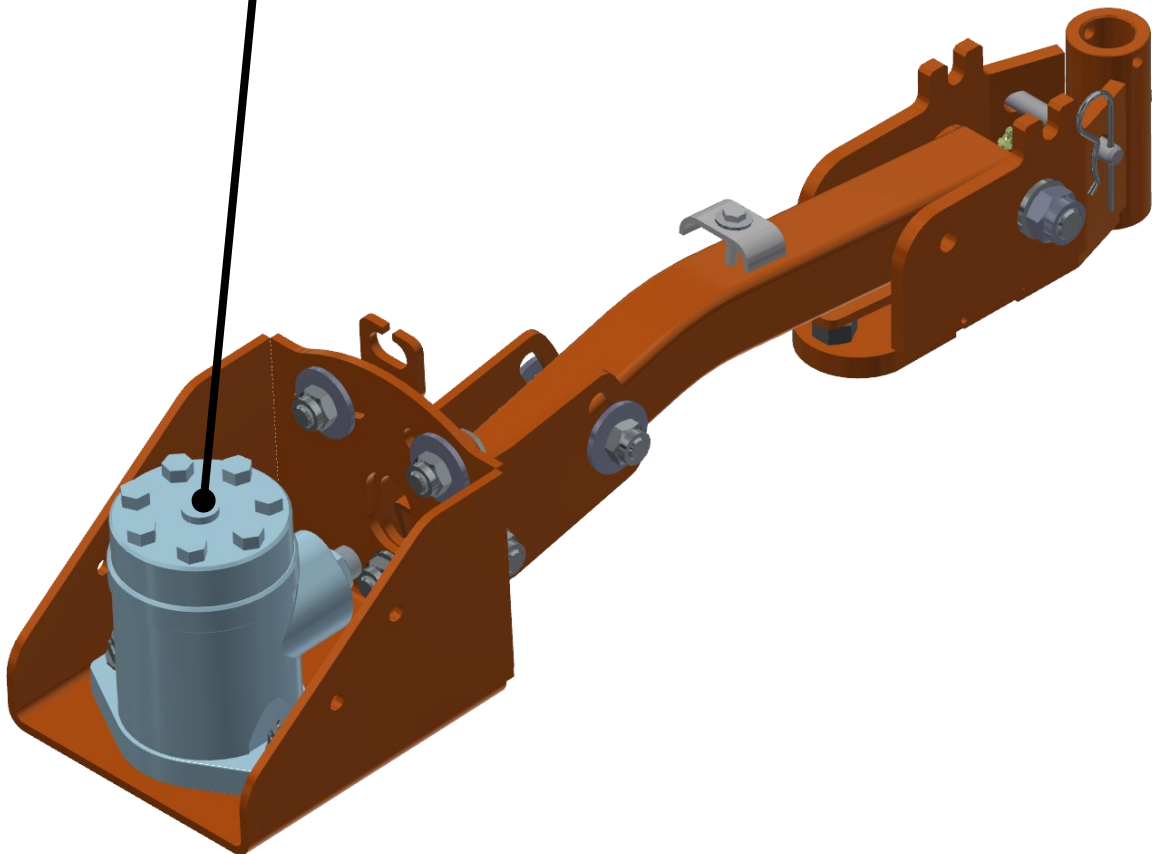

4

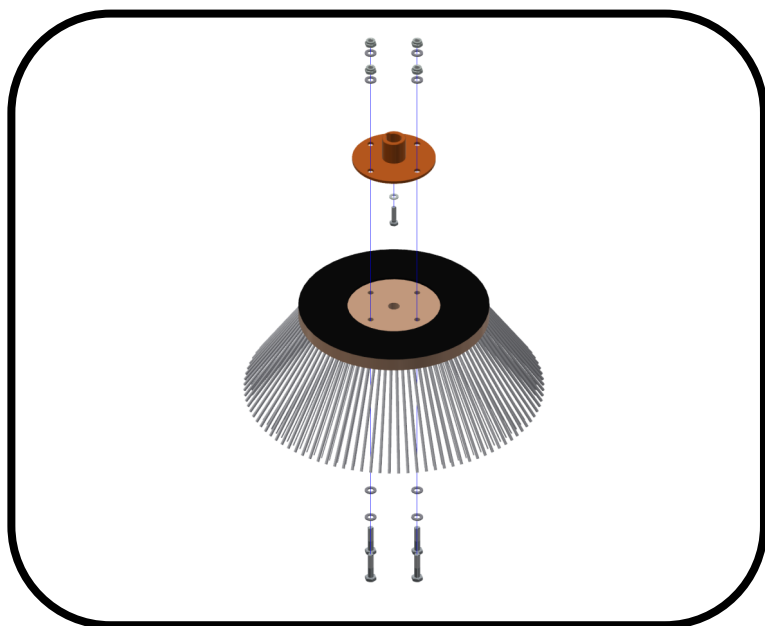

- 4x DIN 931-M10x45
- 1x DIN 933-M8x30
- 4x DIN 985-M10
- 8x DIN 125-A10.5
- 1x DIN 125-A8.4

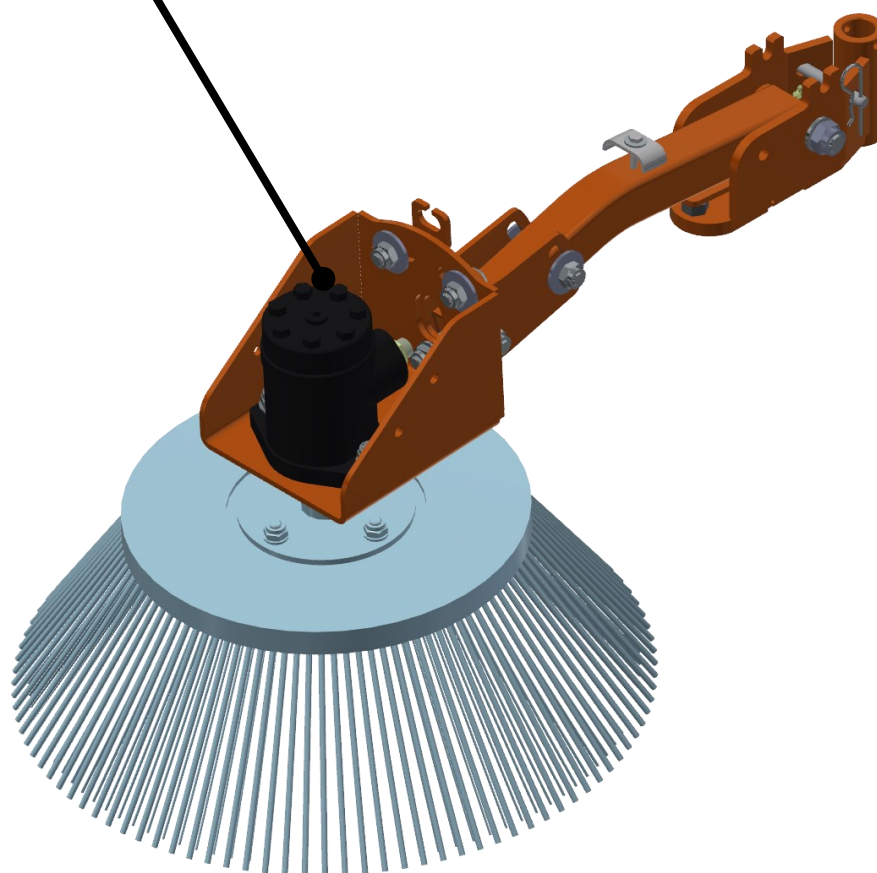

5

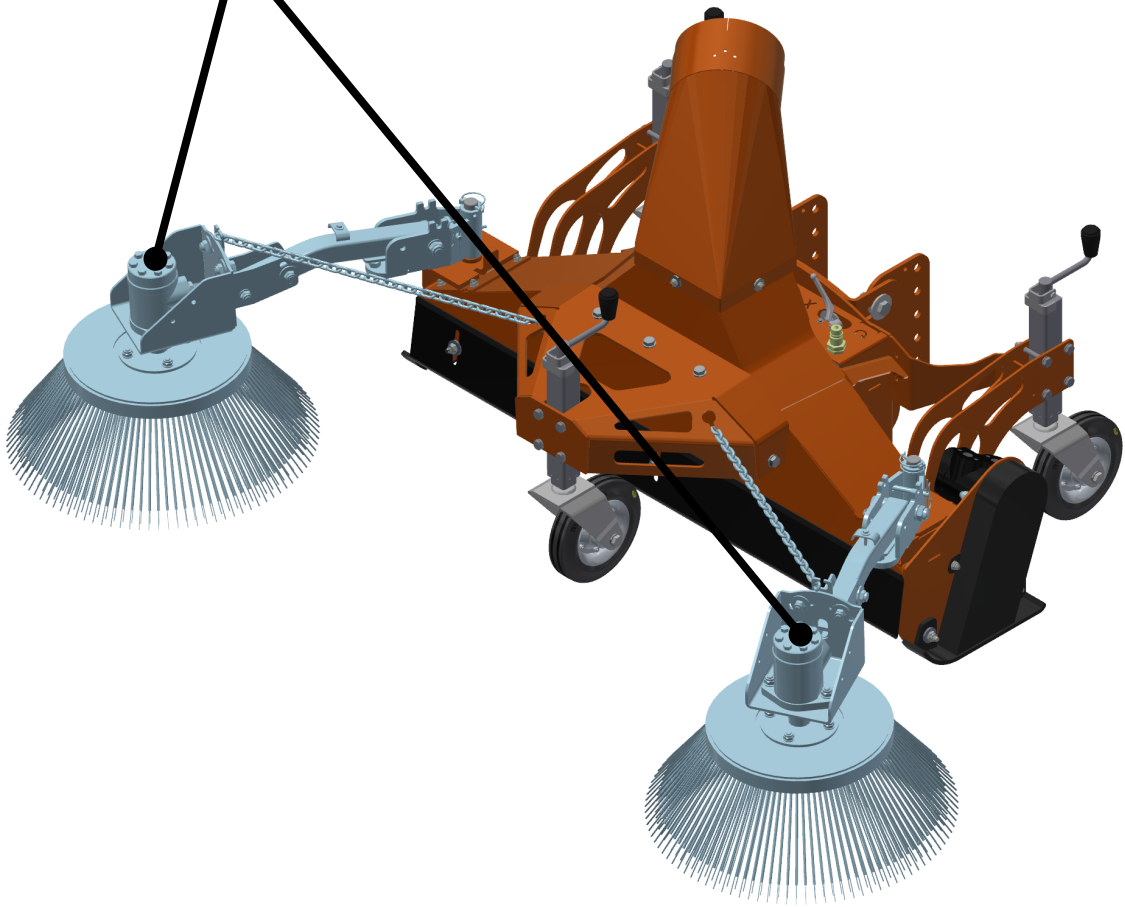
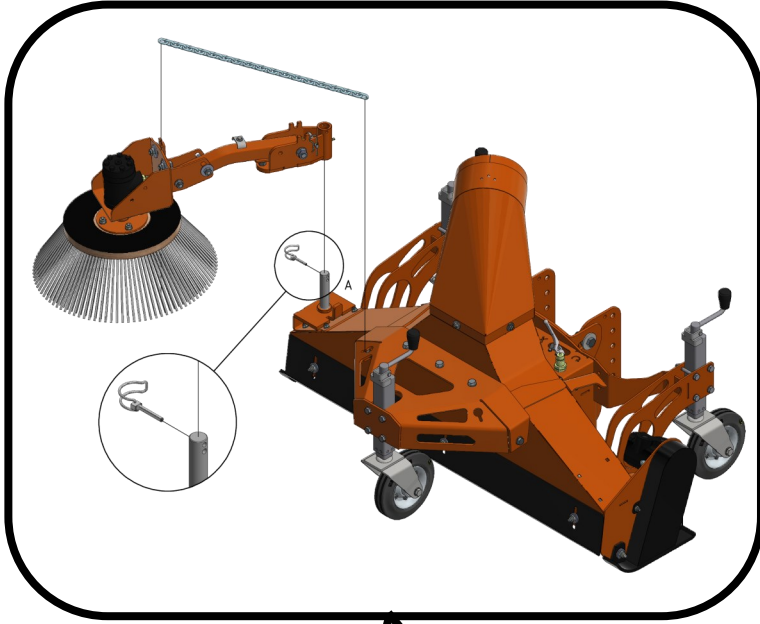

MRM

Montageanleitung Mounting assembly

Bedienpanel Seitenbesen Operating panel side broom

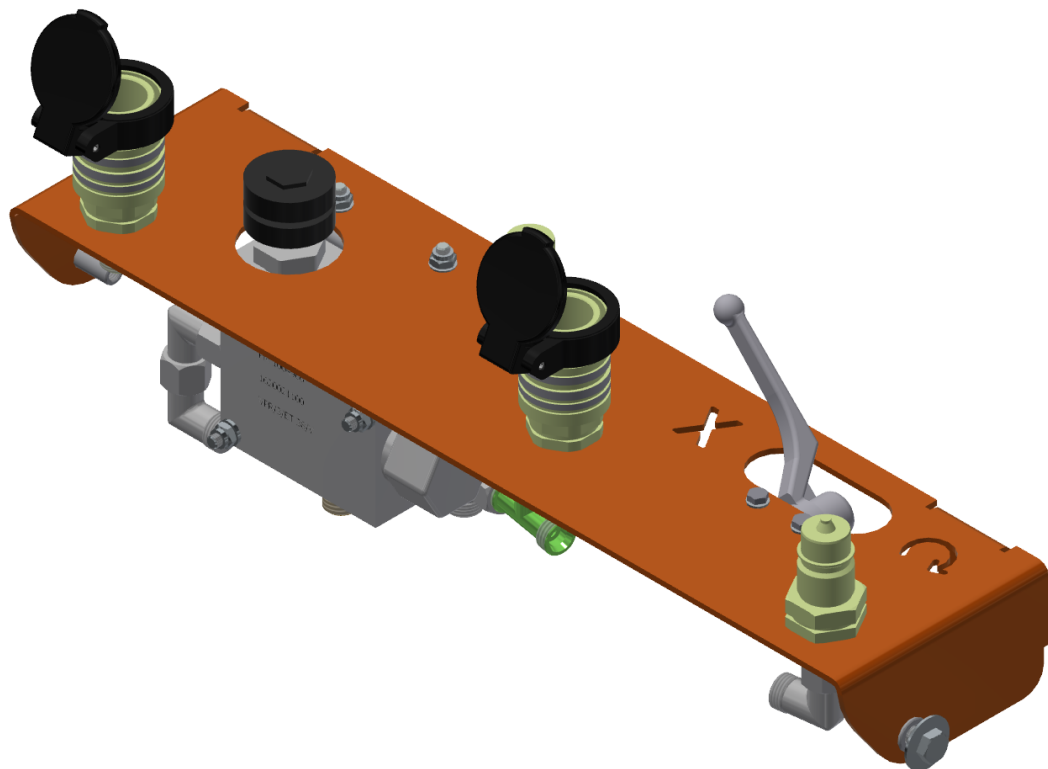

1

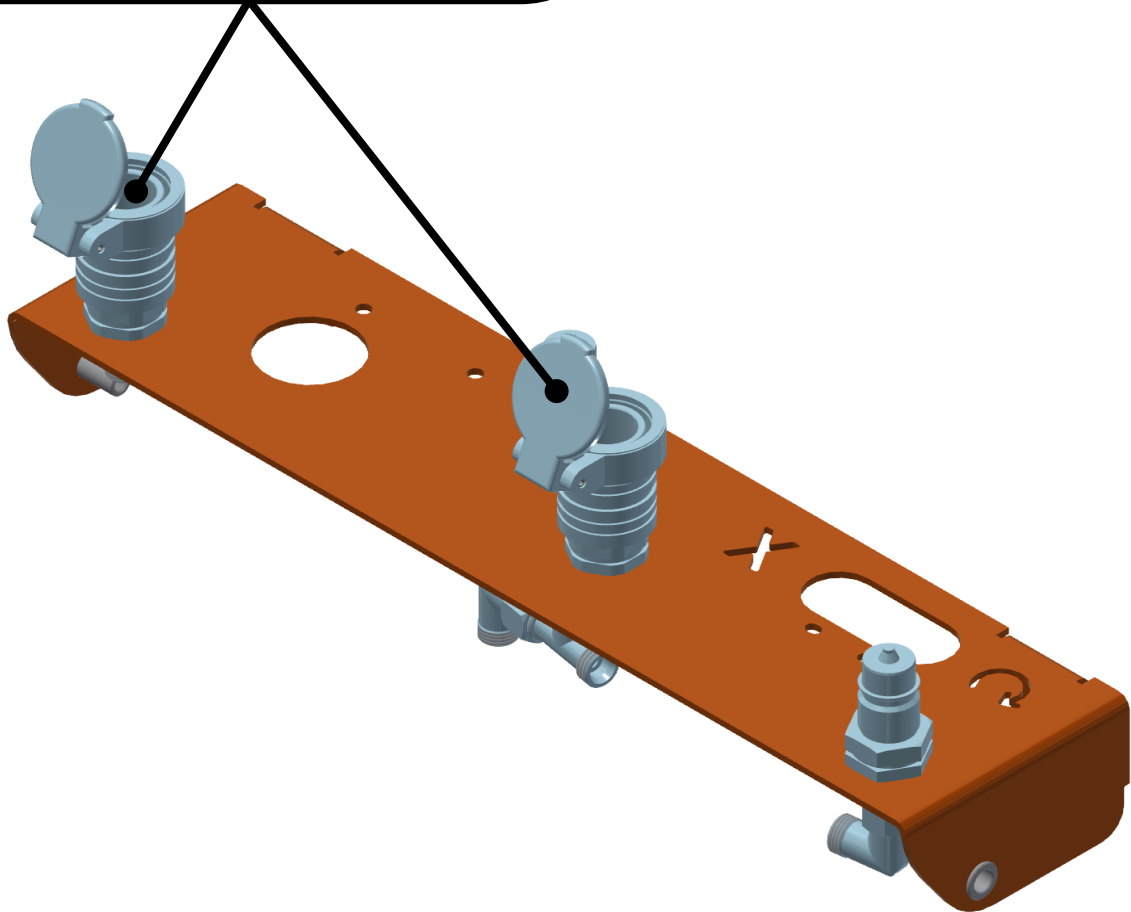
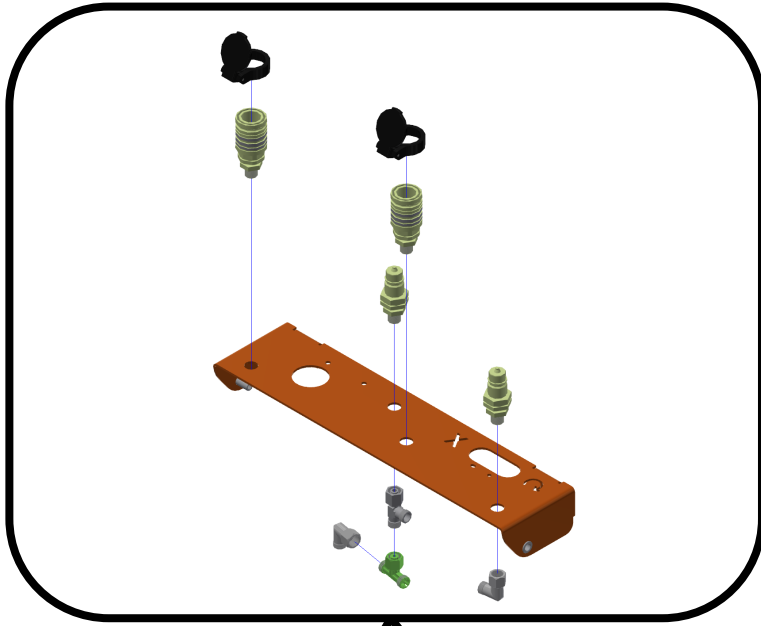

2

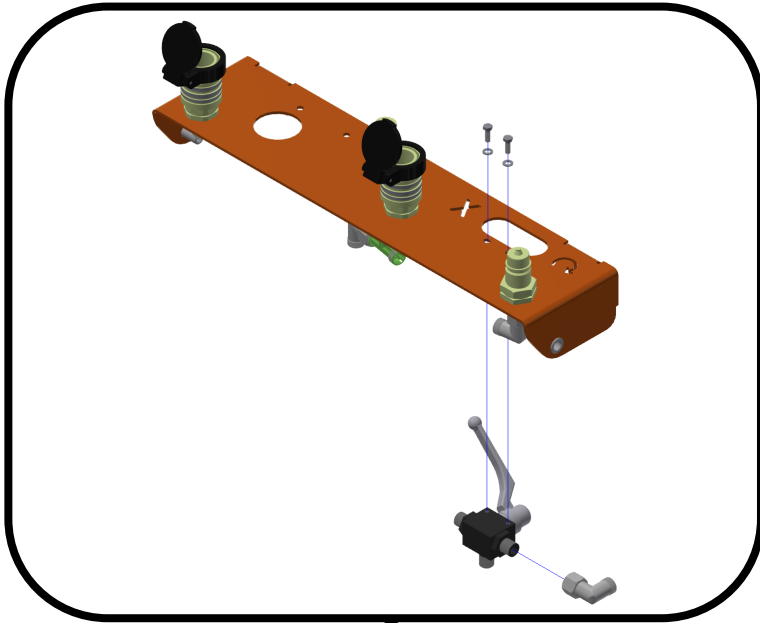

2x DIN 933-M12x40

2x DIN 985-M12

4x DIN 125-A13

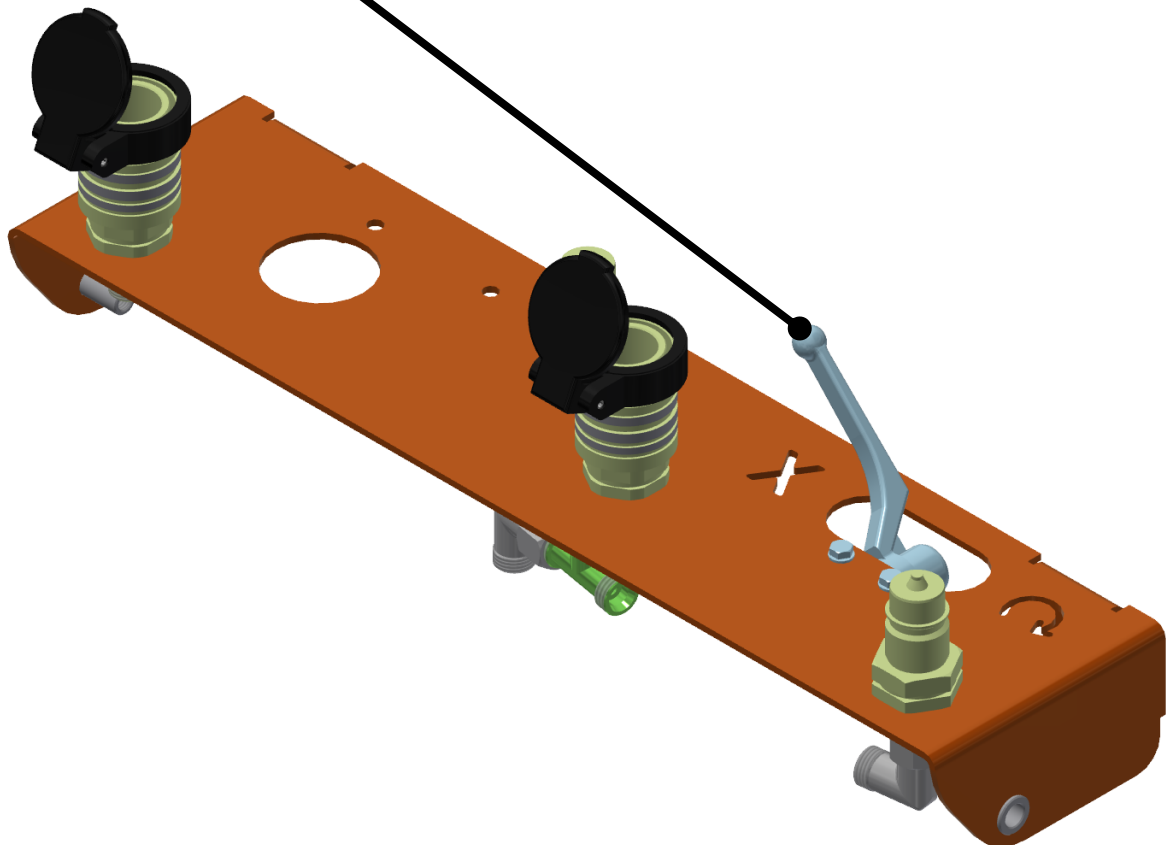

3

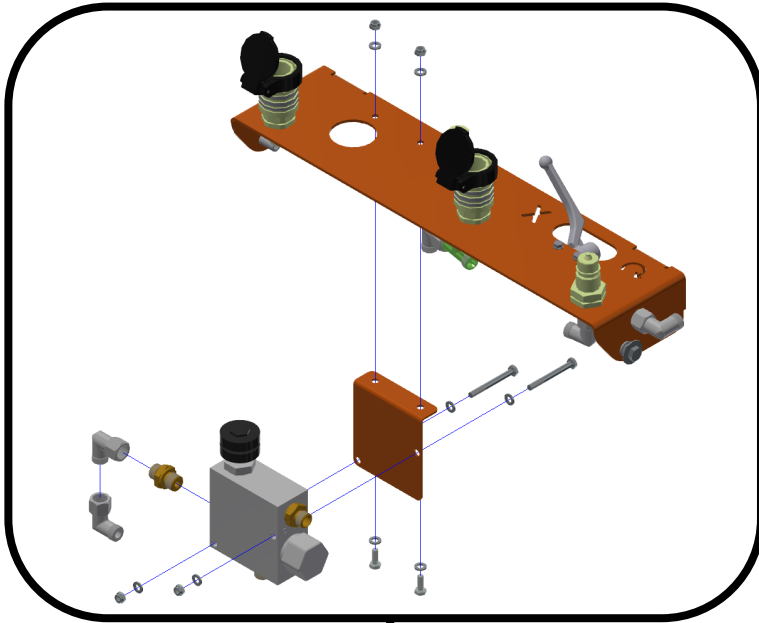

- 4x DIN 931-M10x45
- 1x DIN 933-M8x30
- 4x DIN 985-M10
- 8x DIN 125-A10.5
- 1x DIN 125-A8.4

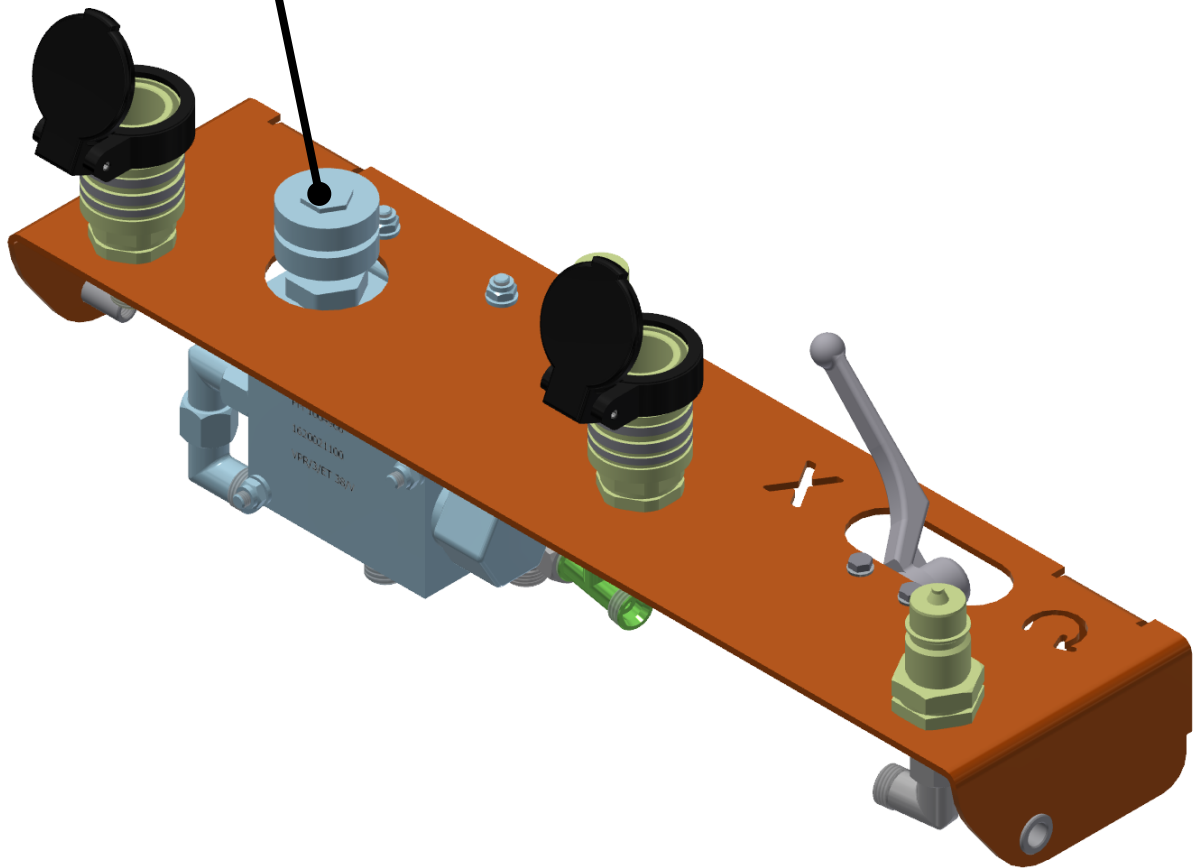

4



A1



A2

Ø8 x 400

B1



B2

Ø8 x 400

C1



C2

Ø8 x 400

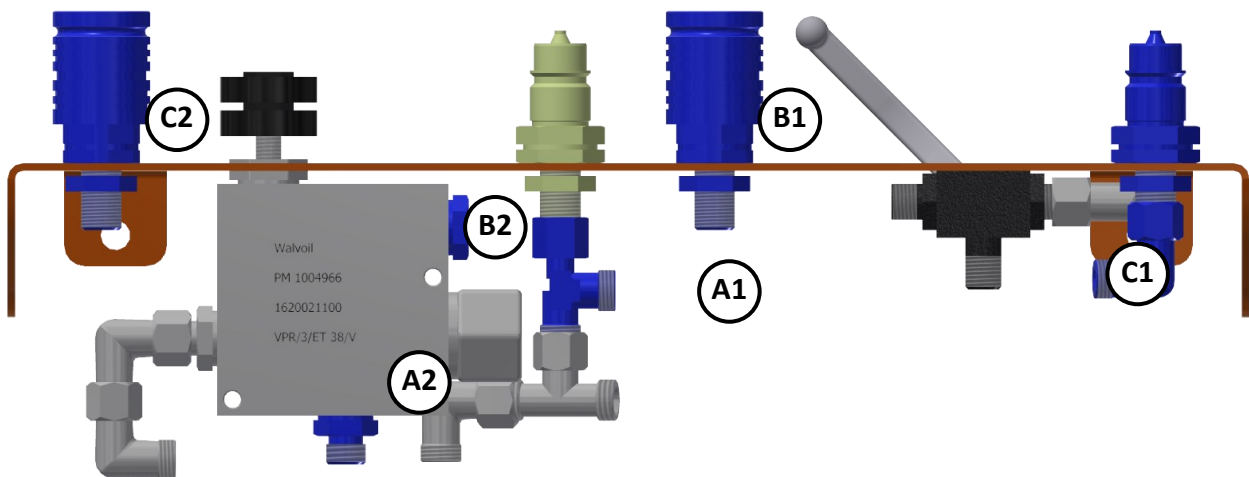

5



D1



D2

Ø8 x 400

E1



E2

Ø8 x 400

F1



->6

Ø8 x 850

G1



->7

Ø8 x 1700

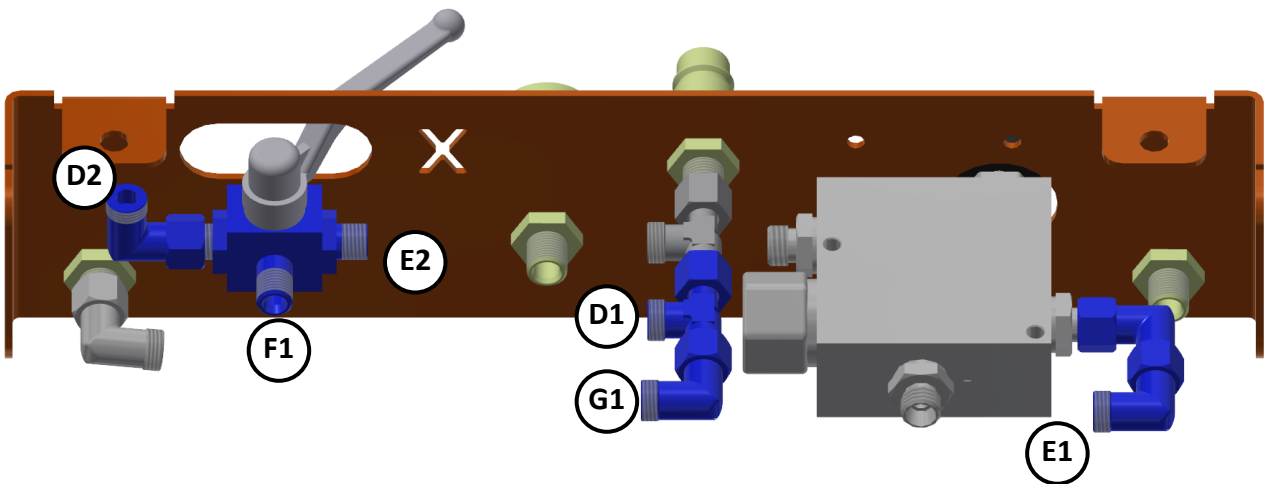

6

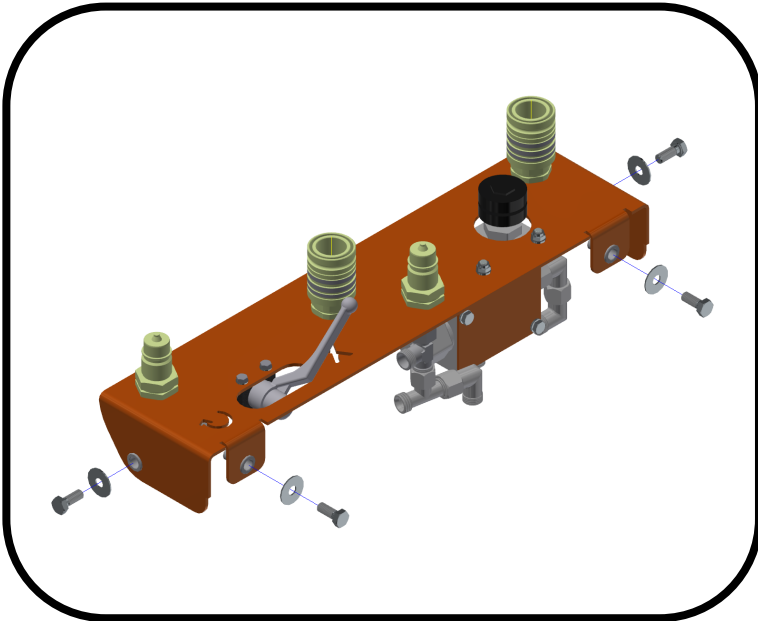

2x DIN 933-M12x40

2x DIN 985-M12

4x DIN 125-A13

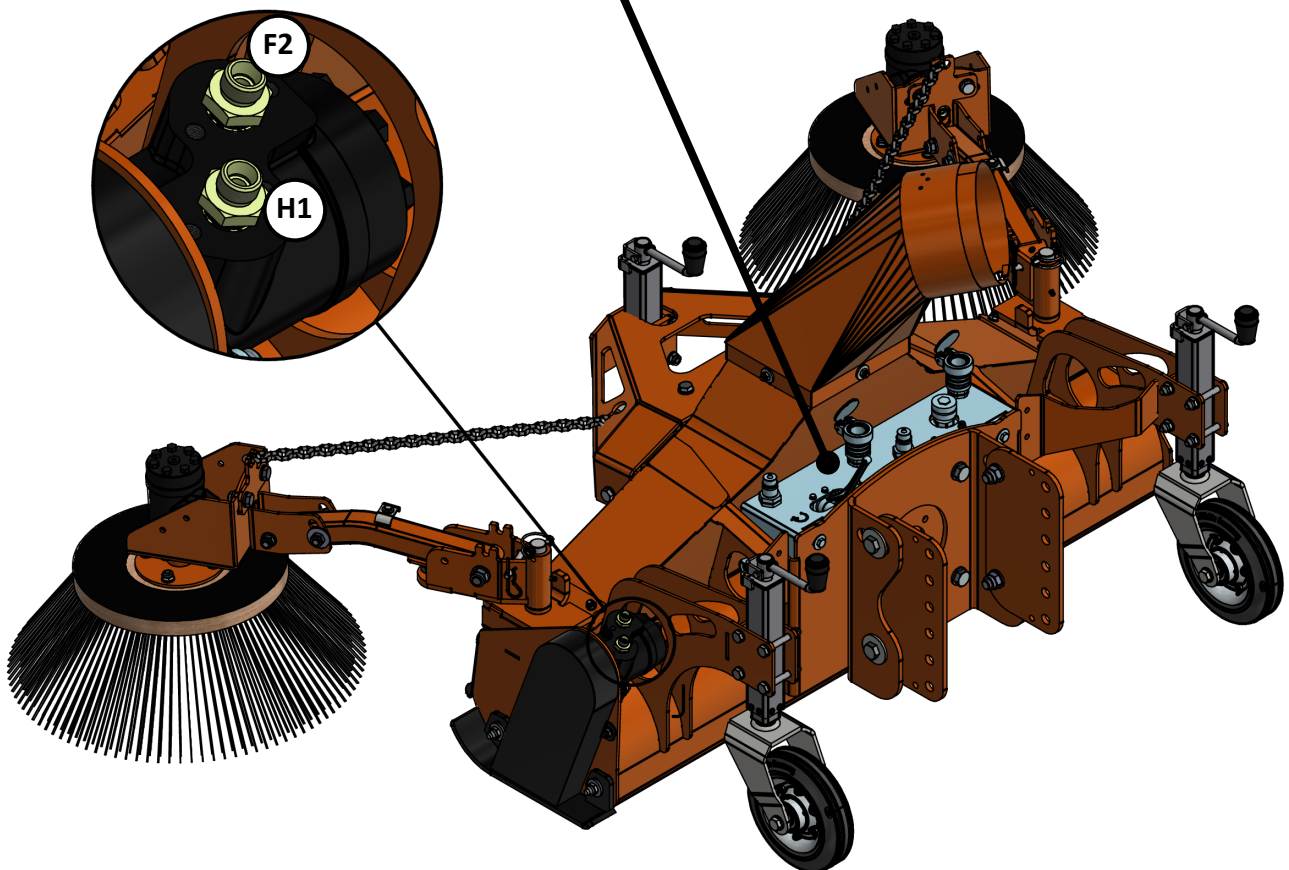

7



->5



G2 Ø8 x 1700

->6



H2 Ø8 x 1700

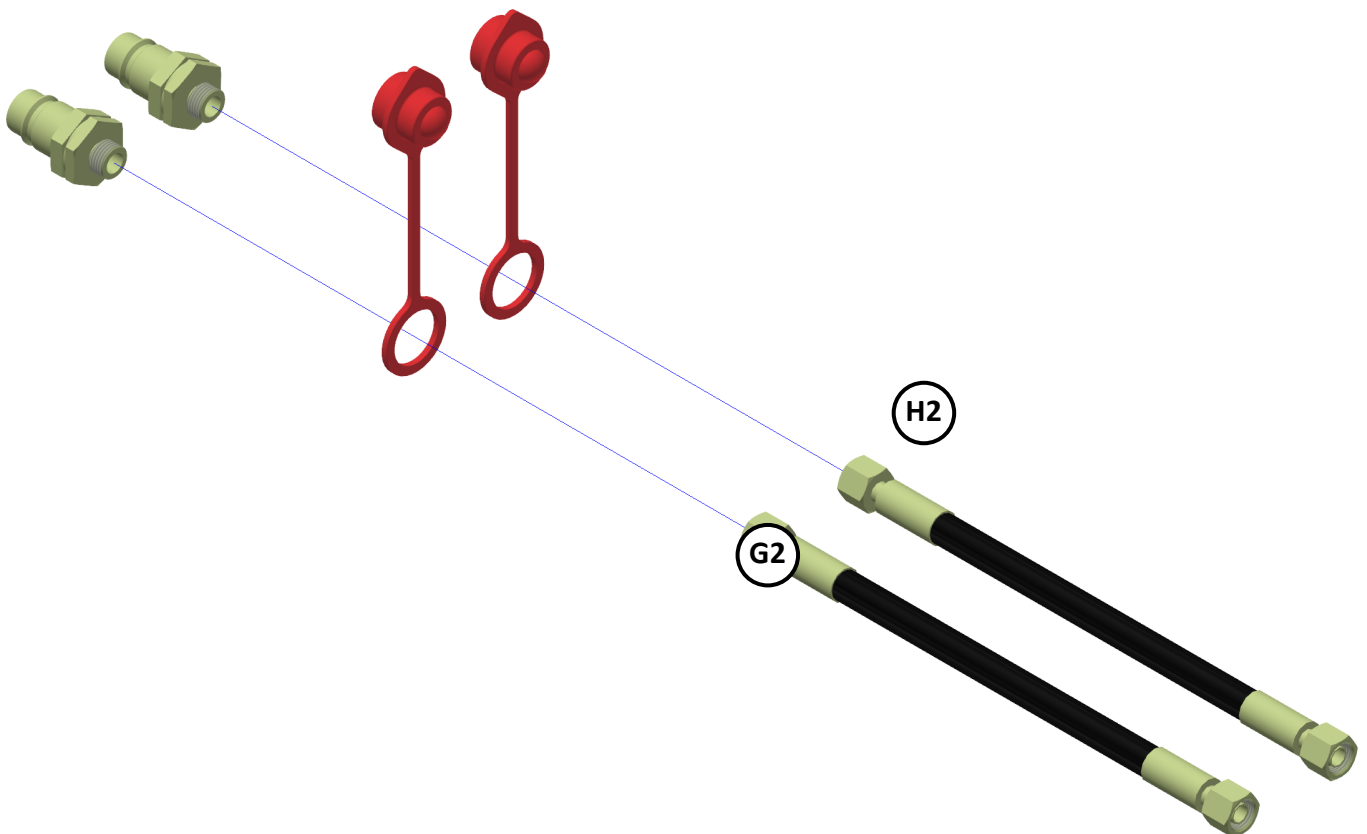

MRM Andrückrolle Pressing roller

Montageanleitung Mounting assembly

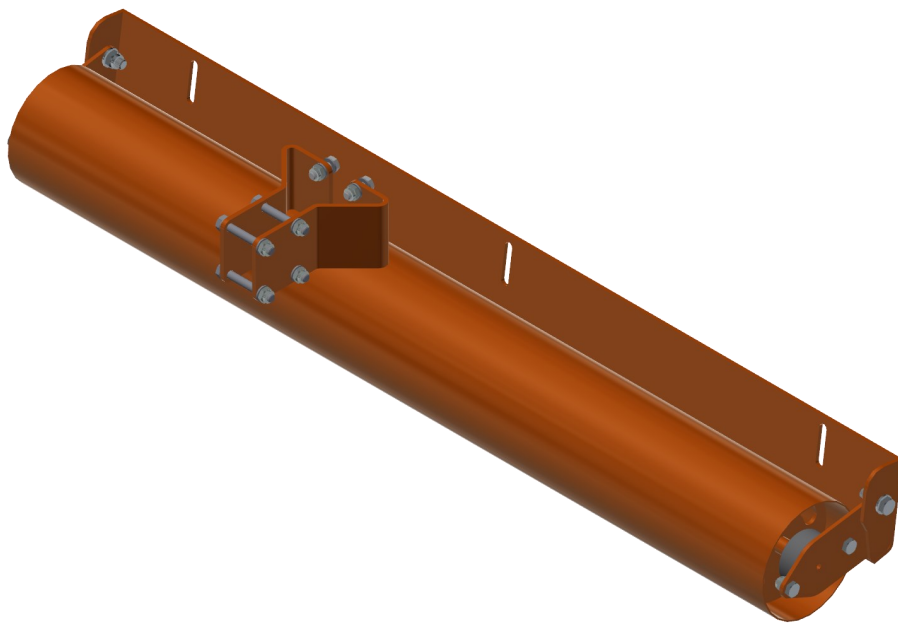

1

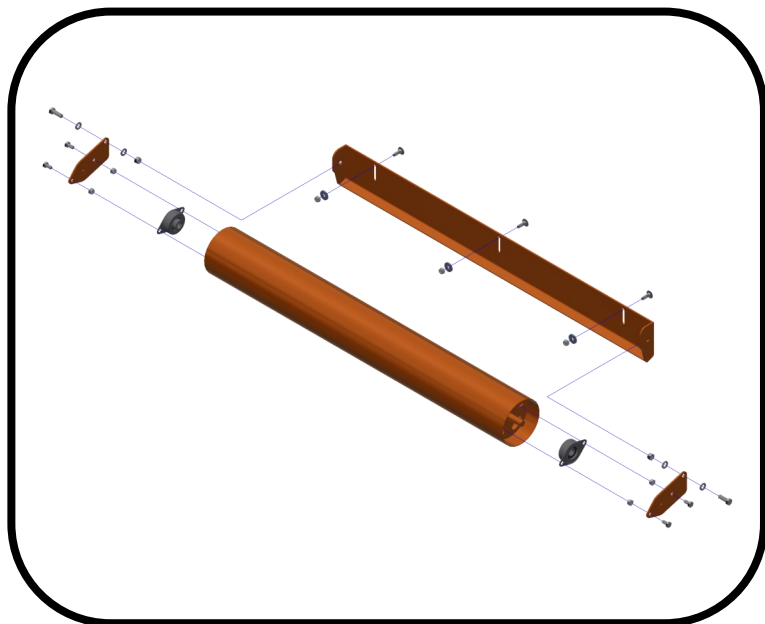

- 2x DIN 933-M12x35
- 4x DIN 933-M10x20
- 3x DIN 603-M10x30
- 2x DIN 985-M12
- 7x DIN 985-M10
- 2x DIN 125-A13
- 3x DIN 522-10.5x30x4

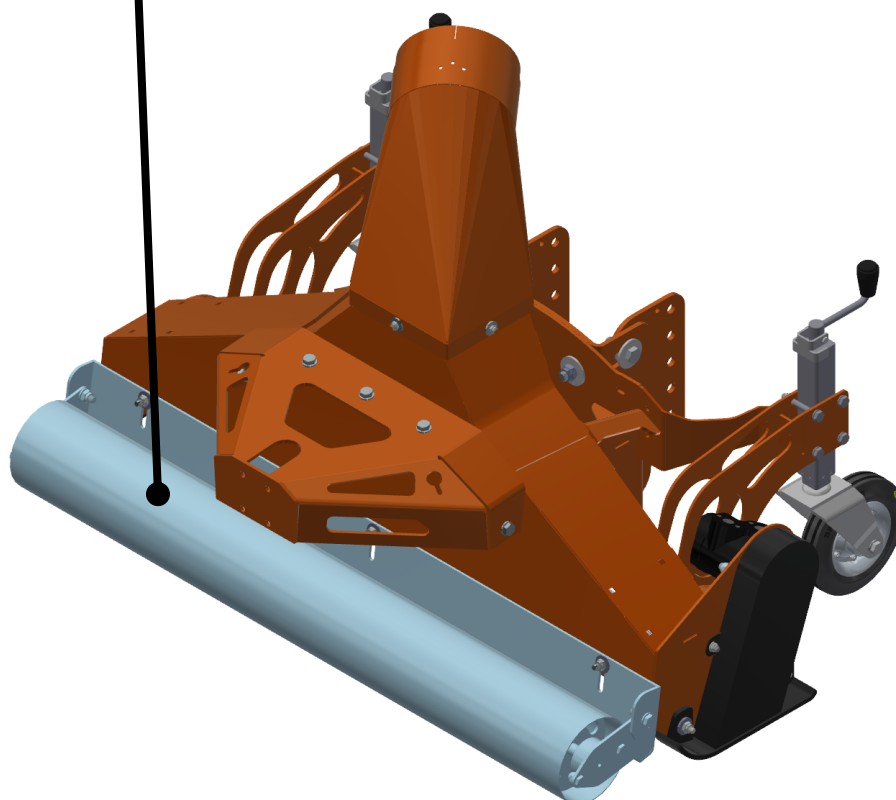

2

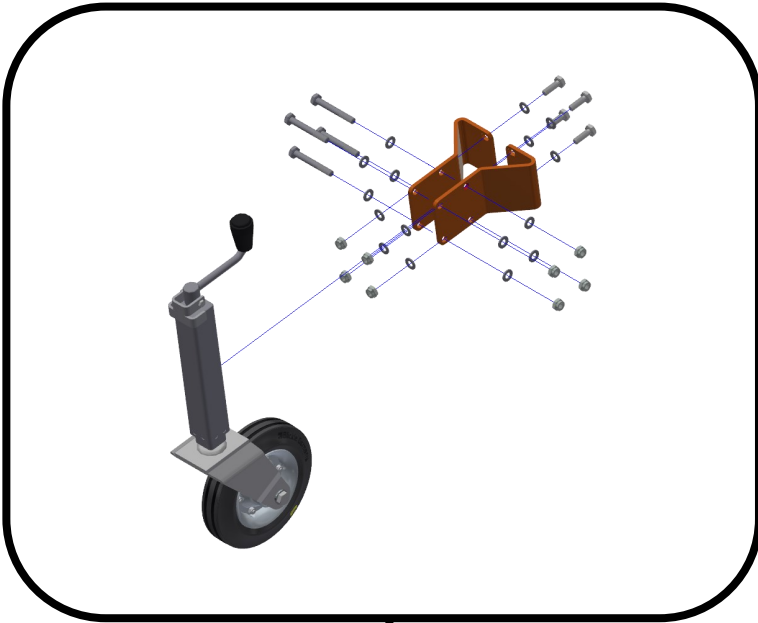

4x DIN 931-M10x75
4x DIN 933-M10x30
8x DIN 985-M10
16x DIN 125-A10.5

